

### Key Design Elements

- Coastal Landscape layout focuses around revised building structure
- Sealed asphalt road meanders through the site with a turn around at the end leading to Red Rocks
- Natural surface path network sits apart from the road to allow pedestrian and cyclists to access the site without vehicle interference
- Carpark areas in chipseal provide a natural surface for a variety of parking for both large and small vehicles
- Finished levels on the deck outside the building sit approximately 1 metre above carpark levels for best views out and over the site to the sea
- Areas around the building provide areas for sitting and gathering including on the deck area, in the sheltered large timbered seat area on the west side, out the front by the sign/mapboard
- Use of coastal theme materials of exposed aggregates/largish timbers/rocks as per the South Coast Management Plan
- All planted areas to be in native plantings sources locally

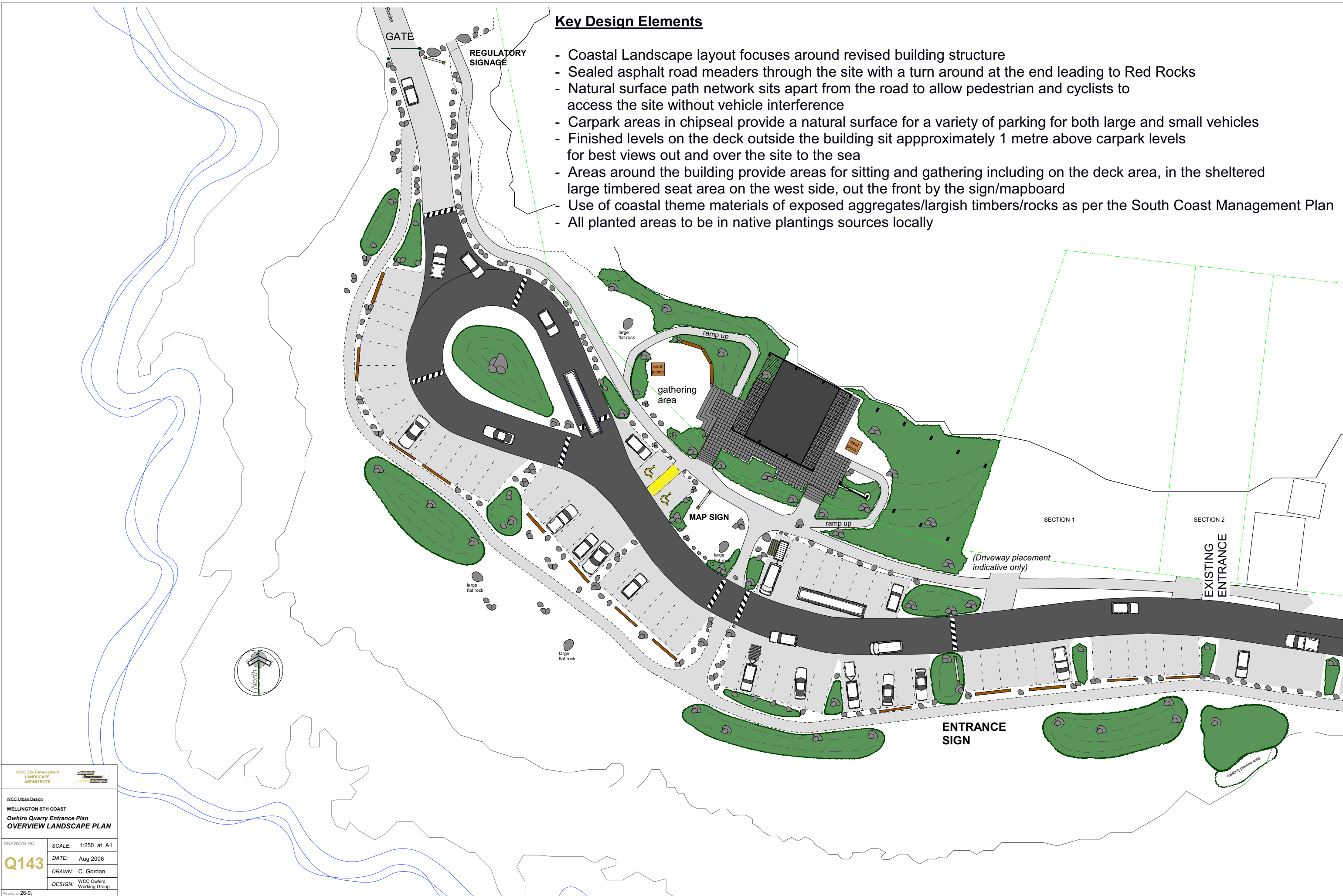

WCC City Development  
LANDSCAPE ARCHITECTS

WCC Urban Design  
WELLINGTON STH COAST  
Owhiro Quarry Entrance Plan  
OVERVIEW LANDSCAPE PLAN

DRAWING NO.	SCALE: 1:250 at A1
<b>Q143</b>	DATE: Aug 2006
	DRAWN: C. Gordon
	DESIGN: WCC Owhiro Working Group

Revision: 26-9.