MINUTES

WEDNESDAY 23 MAY 2007

5.32PM

**Council Chamber
First Floor, Town Hall
Wakefield Street
Wellington**

PRESENT:

Mayor Prendergast
Councillor Ahipene-Mercer
Councillor Armstrong
Councillor Cook
Councillor Foster
Councillor Gill
Councillor Goulden (5.32 – 5.47pm, 6.15 – 6.31pm)
Councillor McKinnon
Councillor Morrison
Councillor Pepperell
Councillor Ritchie
Councillor Ruben
Councillor Shaw (5.35 – 6.31pm)
Councillor Wade-Brown
Councillor Wain

APOLOGIES:

Councillor Shaw (lateness)

0068/07C **APOLOGIES**
(1215/11/IM)

Moved Mayor Prendergast, seconded Councillor Goulden, the motion that apologies for absence be received for lateness from Councillor Shaw.

The motion was put and declared CARRIED on voices.

RESOLVED:

THAT Council:

1. *Accept apologies for lateness from Councillor Shaw.*

069/07C **CONFIRMATION OF MINUTES**
(1215/11/IM)

Moved Mayor Prendergast, seconded Councillor McKinnon the motion that Council approve the minutes of the meetings held on Wednesday 21 March 2007 and Thursday 26 April 2007 having been circulated, be taken as read and confirmed as an accurate record of those meetings.

The motion was put.

Voting for: Mayor Prendergast, Councillors Ahipene-Mercer, Armstrong, Cook, Foster, Gill, Goulden, McKinnon, Morrison, Pepperell, Ritchie, Ruben, Shaw, Wade-Brown, Wain,

Voting against: Nil.

Majority Vote: 15:0

The motion was declared CARRIED.

RESOLVED:

THAT Council

1. *Approve the minutes of the meeting held on Wednesday 21 March 2007 and Thursday 26 April 2007 having been circulated, be taken as read and confirmed as an accurate record of those meetings.*

070/07C **PUBLIC PARTICIPATION**
(1215/11/IM)

NOTED:

There was no public participation.

071/07C **DEPUTATION**
(1215/11/IM)

(Councillor Shaw joined the meeting at 5.35pm)

NOTED:

Diane Calvert and Craig Beedall representing the Ngaio and Khandallah Residents' Action Group made a deputation relating to the proposed implementation of 'Adshel' Bus shelters around the city. They reinforced that the group supported effective public transport strategies, the principles of the New Zealand Urban Design Protocol and robust and transparent Council processes. The group noted their opposition to the proposed 'Adshel' bus shelters due to their impact on the city streetscape, the inadequate shelter they believe they provide and the appropriateness of the placement of some advertising material. They stated that they could not see the relationship between implementation of the bus shelters and the NZ Urban Design protocol and questioned the Resource Consent processes through which the bus shelters were being dealt with. Ms Calvert and Mr Beedall also noted the support for the Residents' Action Group outside the Ngaio/Khandallah area and foreshadowed a petition that they would be presenting to the Council with respect to the bus shelters which has already collected over 1000 signatures.

072/07C **ANNOUNCEMENTS BY THE MAYOR**
(1215/11/IM)

NOTED:

The Mayor advised that Report 1 'Adshel Bus Shelters Hearings (report of Commissioner)' would be withdrawn from the agenda due to the following reasons.

Council has agreed to enter into discussions with a number of concerned ratepayers to look towards resolving the issues they have with the Adshel bus shelters being installed throughout the residential areas of the city. As a sign of good faith the 'Adshel Bus Shelter Hearings (Report of Commissioner)' will be withdrawn and presented at next month's meeting (27 June 2007) so as to allow the negotiations between the Council and concerned ratepayers to take place.

She also noted however that the report of the Commissioner was with regard to the decision on objections under s.339 of the Local Government Act and that the process stipulated in s.339 of the LGA has been followed.

073/07C **PETITIONS**
(1215/11/IM)

NOTED:

There were no petitions.

074/07C **CONFLICT OF INTEREST DECLARATIONS**
(1215/11/IM)

NOTED:

1. Councillor Ruben declared a conflict of interest with respect to Report 10 Appointments to Council Controlled Organisations relating to one matter contained in the recommendations. He advised that he would withdraw from the meeting when the matter was debated and voted on.
2. Councillor Foster declared a conflict of interest with respect to Report 5 – Strategy and Policy Committee, meeting of Thursday 5 April, ITEM 061/07P, Khouri Avenue Reserve Land Exchange. He advised that he would withdraw from discussion and voting on the matter.
3. Councillor Ritchie declared a conflict of interest during debate on Report 10 – Appointment to Council Controlled Organisations and withdrew from discussion and voting on one matter contained within the recommendations. Please see Item 84/07C below.

General Business

075/07C **ADSHEL BUS SHELTERS HEARINGS (REPORT OF COMMISSIONER)**

Report of Ian Hutchings – “Officer” of Council (with delegated authority to hear objections in relation to bus shelters).

(1215/11/IM)

(REPORT 1)

NOTED:

It was noted that this item was withdrawn from the agenda and would be considered by Council on 27 June 2007.

076/07C **APPROVAL OF PROPOSED DISTRICT PLAN CHANGE NO. 44 - GENERAL MINOR AMENDMENTS TO DISTRICT PLAN TEXT AND MAPS II**

APPROVAL OF PROPOSED DISTRICT PLAN VARIATION 1 - ADDITIONS TO PROPOSED DISTRICT PLAN CHANGE 33 (RIDGELINES & HILLTOPS (VISUAL AMENITY) & RURAL AREA)

(1215/11/IM)

(REPORT 2)

(Councillor Goulden left the meeting at 5.47pm)

Moved Councillor Shaw, seconded Councillor Wain the substantive motion.

The substantive motion was put.

Voting for: Mayor Prendergast, Councillors Ahipene-Mercer, Armstrong, Cook, Foster, Gill, McKinnon, Morrison, Pepperell, Ritchie, Ruben, Shaw, Wade-Brown, Wain,

Voting against: Nil.

Majority Vote: 14:0

The substantive motion was declared CARRIED.

RESOLVED:

THAT Council:

- 1. Approve the recommendations of the District Plan Hearing Committee in respect of District Plan Change 44 – General Minor Amendments to District Plan Text and Maps II as set out in Appendices One & Two of this report.*
- 2. Approve the recommendations of the District Plan Hearing Committee in respect of District Plan Variation 1 - Additions to Proposed District Plan Change 33 (Ridgelines & Hilltops (Visual Amenity) & Rural Area) as set out in Appendix Three.*

077/07C **ASIA PACIFIC CITIES SUMMIT 2007, BRISBANE, FRIDAY 31 AUGUST TO MONDAY 3 SEPTEMBER 2007**

Report of Nicola Hay – Committee Advisor.
(1215/11/IM)

(REPORT 3)

Moved Mayor Prendergast, seconded Councillor Foster the substantive motion.

The substantive motion was put.

Voting for: Mayor Prendergast, Councillors Ahipene-Mercer, Armstrong, Cook, Foster, Gill, McKinnon, Morrison, Pepperell, Ritchie, Ruben, Shaw, Wade-Brown, Wain,

Voting against: Nil.

Majority Vote: 14:0

The substantive motion was declared CARRIED.

RESOLVED:

THAT Council:

1. *Receive the information.*
2. *Approve the attendance of the Mayor and one Councillor at the 'Asia Pacific Cities' Summit to be held in Brisbane, Australia, Friday 31 August – Monday 3 September 2007 and agree that the costs associated with attending the conference are met from the Elected Members Budget (GVEM01).*
3. *Note that if Council submit a bid for Wellington to host the 2009 Asia Pacific Cities Summit which is shortlisted, registration for one attendee will be complimentary.*
4. *Note that a report back on the meeting will be presented to the Strategy and Policy Committee meeting in accordance with Council policy.*

NOTED:

There were no nominees to attend this conference with Mayor Prendergast.

078/07C **LGNZ ANNUAL CONFERENCE, DUNEDIN, SUNDAY 15 TO WEDNESDAY 18 JULY 2007**

Report of Nicola Hay – Committee Advisor.
(1215/11/IM)

(REPORT 1)

Moved Councillor Shaw, seconded Mayor Prendergast the substantive motion.

The substantive motion was put.

Voting for: Mayor Prendergast, Councillors Ahipene-Mercer, Armstrong, Cook, Foster, Gill, McKinnon, Morrison, Pepperell, Ritchie, Ruben, Shaw, Wade-Brown, Wain,

Voting against: Nil.

Majority Vote: 14:0

The substantive motion was declared CARRIED.

RESOLVED:

THAT Council:

1. *Receive the information.*
2. *Approve the attendance of the Mayor and up to four elected members, including the Chair of the Tawa Community Board, at the Local Government New Zealand 'Investing in our Future' Conference to be held in Dunedin from 15 – 18 July 2007 and agree that the costs associated with attending the conference are met from the Elected Members Budget (GVEM01).*
3. *Note that Wellington City Council can appoint up to four delegates to attend the Local Government New Zealand Annual General Meeting on Wednesday 18 July 2007.*
4. *Appoint the following delegates to attend the Local Government New Zealand AGM to be held on Wednesday 18 July 2007:*
 - (a) *Mayor Prendergast as its presiding delegate, with authority to exercise Wellington City Council's six votes;*
 - (b) *an alternate presiding delegate (in the event that the Mayor is absent from the floor of the meeting at any time), who shall be a Councillor; and*
 - (c) *two other delegates, who shall be Councillors*
5. *Note that there is a Strategy and Policy Committee Agenda meeting and a Capacity Board meeting on 17 July and a Capacity Board meeting and a Pacific Advisory Group meeting on 18 July.*

6. *Note that a report back on the meeting will be presented to the Strategy and Policy Committee meeting in accordance with Council policy.*

NOTED:

There were no nominees to attend this conference with Mayor Prendergast and the Chair of the Tawa Community Board.

Reports from Committees – Part A Committee Decisions requiring Council approval

079/07C **STRATEGY AND POLICY COMMITTEE**
Meeting of Thursday 5 April 2007
(1215/11/IM) (REPORT 5)

(Councillor Foster withdrew from the table at 6.12pm)

1. **ITEM 061/07P KHOURI AVENUE RESERVE LAND EXCHANGE**
(1215/52/IM) (REPORT 2)

Moved Councillor Wade-Brown, seconded Councillor Morrison the substantive motion

The substantive motion was put.

Voting for: Mayor Prendergast, Councillors Ahipene-Mercer, Armstrong, Cook, Gill, McKinnon, Morrison, Pepperell, Ritchie, Ruben, Shaw, Wade-Brown, Wain,

Voting against: Nil.

Majority Vote: 13:0

The substantive motion was declared CARRIED.

RESOLVED:

THAT Council:

1. *Use its delegated powers under section 15 of the Reserves Act 1977 in considering firstly the authorisation of the proposed exchange, and secondly the request for the exchange.*

2. *Approve the exchange of part of the Recreation Reserve at Sec 1 SO 32138 as marked Area A in figure One for part of the fee simple land at Lot 2 DP 52184 as marked Area B in figure One under section 15 of the Reserves Act 1977.*

See Appendix One of these minutes for Figure One which is the Reserve Land Exchange areas

(Councillor Foster returned to the table at 6.12pm)

080/07C **STRATEGY AND POLICY COMMITTEE**
Meeting of Thursday 10 May 2007
(1215/11/IM)

(REPORT 6)

1. **ITEM 101/07P HEALTH LICENCES AND DOG REGISTRATION CHARGES FOR 2007/08**
(1215/52/IM) (REPORT 2)

Moved Mayor Prendergast, seconded Councillor McKinnon the substantive motion

The substantive motion was put.

Voting for: Mayor Prendergast, Councillors Ahipene-Mercer, Armstrong, Cook, Foster, Gill, McKinnon, Morrison, Pepperell, Ritchie, Ruben, Shaw, Wade-Brown, Wain,

Voting against: Nil.

Majority Vote: 14:0

The substantive motion was declared CARRIED.

RESOLVED:

THAT Council:

1. *Agree to recommend that the Council agreed to the fees and charges for health licences and dog registrations (outlined in Appendix Two of these minutes).*
 2. *Note that the fees will be applicable from 1 July 2007.*
2. **ITEM 102/07P IMPLEMENTATION OF E-DEMOCRACY INITIATIVES AND ASSOCIATED STANDING ORDERS CHANGES**
(1215/52/IM) (REPORT 3)

Moved Councillor Shaw, seconded Councillor Ritchie the substantive motion

The substantive motion was put.

Voting for: Mayor Prendergast, Councillors Ahipene-Mercer, Cook, Foster, Gill, McKinnon, Morrison, Pepperell, Ritchie, Ruben, Shaw, Wade-Brown, Wain,

Voting against: Councillor Armstrong

Majority Vote: 13:1

A three-quarters majority was reached as required by standing order 14 to amend standing orders. The substantive motion was declared CARRIED.

RESOLVED:

THAT Council:

1. *Agree to recommend to Council that Standing Orders 222 – 224 be amended as attached at Appendix Three of these minutes.*

**3. ITEM 103/07P TRAFFIC RESOLUTIONS
(1215/52/IM) (REPORT 5)**

Moved Mayor Prendergast, seconded Councillor Ahipene-Mercer the substantive motion

The substantive motion was put.

Voting for: Mayor Prendergast, Councillors Ahipene-Mercer, Armstrong, Cook, Foster, Gill, McKinnon, Morrison, Pepperell, Ritchie, Ruben, Shaw, Wade-Brown, Wain,

Voting against: Nil.

Majority Vote: 14:0

The substantive motion was declared CARRIED.

RESOLVED:

THAT Council:

1. Approve the following amendments pursuant to the provisions of the Wellington City Council Consolidated Bylaw 1991 Part 18 (Traffic):

a) **GIVE WAY – BENARES STREET – ONSLOW ROAD – KHANDALLAH – (34-07)**

Delete from Schedule D (No Stopping Restrictions) of the Traffic Restrictions Schedule.

<i>Column One</i>	<i>Column Two</i>	<i>Column Three</i>
Madras Street	No Stopping At All Times.	East side, commencing at its intersection with Delhi Crescent and extending in a northerly direction following the eastern kerbline for 15 metres.

Add to Schedule G (Give Way and Stop Controls) of the Traffic Restrictions Schedule.

<i>Column One</i>	<i>Column Two</i>	<i>Column Three</i>
Benares Street	Give Way.	Westbound, at its intersection with Onslow Road.

b) **GIVE WAY AND NO STOPPING AT ALL TIMES – DELHI CRESCENT – MADRAS STREET – KHANDALLAH – (35-07)**

Add to Schedule G (Give Way and Stop Controls) of the Traffic Restrictions Schedule.

<i>Column One</i>	<i>Column Two</i>	<i>Column Three</i>
Madras Street	Give Way.	Westbound, at its intersection with Delhi Crescent.

Add to Schedule D (No Stopping Restrictions) of the Traffic Restrictions Schedule.

<i>Column One</i>	<i>Column Two</i>	<i>Column Three</i>
Madras Street	No Stopping At All Times.	North side, commencing at its intersection with Delhi Crescent and extending in an easterly direction

Madras Street	<i>No Stopping At All Times.</i>	<i>following the northern kerbline for 20 metres. South side, commencing at its intersection with Delhi Crescent and extending in an easterly direction following the southern kerbline for 21.5 metres.</i>
----------------------	----------------------------------	--

c) GIVE WAY AND NO STOPPING AT ALL TIMES - GURKHA CRESCENT – MADRAS STREET – KHANDALLAH – (36-07)

Add to Schedule G (Give Way and Stop Controls) of the Traffic Restrictions Schedule.

<i>Column One</i>	<i>Column Two</i>	<i>Column Three</i>
Gurkha Crescent	<i>Give Way.</i>	<i>Eastbound, at its intersection with Madras Street.</i>

Add to Schedule D (No Stopping Restrictions) of the Traffic Restrictions Schedule.

<i>Column One</i>	<i>Column Two</i>	<i>Column Three</i>
Gurkha Crescent	<i>No Stopping At All Times.</i>	<i>North side, commencing at its intersection with Madras Street and extending in a westerly direction following the northern kerbline for 20.5 metres.</i>
Gurkha Crescent	<i>No Stopping At All Times.</i>	<i>South side, commencing at its intersection with Madras Street and extending in a westerly direction following the southern kerbline for 22 metres.</i>

d) GIVE WAY AND NO STOPPING AT ALL TIMES - CASHMERE AVENUE – MANDALAY TERRACE – KHANDALLAH – (37-07)

Delete from Schedule D (No Stopping Restrictions) of the Traffic Restrictions Schedule.

<i>Column One</i>	<i>Column Two</i>	<i>Column Three</i>
<i>Mandalay Terrace</i>	<i>No Stopping At All Times.</i>	<i>North side, commencing east of its intersection with Cashmere Avenue and extending in an easterly direction following the northern kerbline for 15 metres.</i>
<i>Mandalay Terrace</i>	<i>No Stopping At All Times.</i>	<i>East side, commencing north of its intersection with Cashmere Avenue and extending in a northerly direction following the eastern kerbline for 12 metres.</i>
<i>Cashmere Avenue</i>	<i>No Stopping At All Times.</i>	<i>North side, commencing west of its intersection with Mandalay Terrace and extending in a westerly direction following the northern kerbline for 12 metres.</i>
<i>Cashmere Avenue</i>	<i>No Stopping At All Times.</i>	<i>East side, commencing south of its intersection with Mandalay Terrace and extending in a southerly direction following the eastern kerbline for 6 metres.</i>

Add to Schedule G (Give Way and Stop Controls) of the Traffic Restrictions Schedule.

<i>Column One</i>	<i>Column Two</i>	<i>Column Three</i>
-------------------	-------------------	---------------------

Mandalay Terrace ***Give Way.*** ***Westbound, at its intersection with Cashmere Avenue.***

Add to Schedule D (No Stopping Restrictions) of the Traffic Restrictions Schedule.

<i>Column One</i>	<i>Column Two</i>	<i>Column Three</i>
<i>Mandalay Terrace</i>	<i>No Stopping At All Times.</i>	<i>North side, commencing at its intersection with Cashmere Avenue and extending in an easterly direction following the northern kerbline for 22.5 metres.</i>
<i>Mandalay Terrace</i>	<i>No Stopping At All Times.</i>	<i>South side, commencing at its intersection with Cashmere Avenue and extending in an easterly direction following the southern kerbline for 22 metres.</i>
<i>Cashmere Avenue</i>	<i>No Stopping At All Times.</i>	<i>East side, commencing at its intersection with Mandalay Terrace and extending in a northerly direction following the eastern kerbline for 12 metres.</i>
<i>Cashmere Avenue</i>	<i>No Stopping At All Times.</i>	<i>East side, commencing at its intersection with Mandalay Terrace and extending in a southerly direction following the eastern kerbline for 3.5 metres.</i>

e) **GIVE WAY AND NO STOPPING AT ALL TIMES -
CASHMERE AVENUE – RANUI CRESCENT –
KHANDALLAH – (38-07)**

Add to Schedule D (No Stopping Restrictions) of the Traffic Restrictions Schedule.

<i>Column One</i>	<i>Column Two</i>	<i>Column Three</i>
<i>Ranui Crescent (west)</i>	<i>No Stopping At All Times.</i>	<i>North side, commencing at its intersection with Cashmere Avenue and extending in a westerly direction following the northern kerbline for 36 metres.</i>
<i>Ranui Crescent (west)</i>	<i>No Stopping At All Times.</i>	<i>South side, commencing at its intersection with Cashmere Avenue and extending in a westerly direction following the southern kerbline for 30 metres.</i>
<i>Cashmere Avenue</i>	<i>No Stopping At All Times.</i>	<i>West side, commencing at its intersection with Ranui Crescent (west) and extending in a southerly direction following the western kerbline for 6 metres.</i>

Add to Schedule G (Give Way and Stop Controls) of the Traffic Restrictions Schedule.

<i>Column One</i>	<i>Column Two</i>	<i>Column Three</i>
<i>Ranui Crescent (west)</i>	<i>Give Way.</i>	<i>Eastbound, at its intersection with Cashmere Avenue.</i>
<i>Ranui Crescent (north-east)</i>	<i>Give Way.</i>	<i>Southwest bound, at its intersection with Cashmere Avenue.</i>

f) GIVE WAY AND NO STOPPING AT ALL TIMES – OMAR STREET – RANGOON STREET – KHANDALLAH – (39-07)

Add to Schedule G (Give Way and Stop Controls) of the Traffic Restrictions Schedule.

<i>Column One</i>	<i>Column Two</i>	<i>Column Three</i>
<i>Omar Street</i>	<i>Give Way.</i>	<i>Eastbound, at its intersection with Rangoon Street.</i>

Add to Schedule D (No Stopping Restrictions) of the Traffic Restrictions Schedule.

<i>Column One</i>	<i>Column Two</i>	<i>Column Three</i>
<i>Omar Street</i>	<i>No Stopping At All Times.</i>	<i>North side, commencing at its intersection with Rangoon Street and extending in an easterly direction following the northern kerbline for 23 metres.</i>
<i>Omar Street</i>	<i>No Stopping At All Times.</i>	<i>South side, commencing at its intersection with Rangoon Street and extending in an easterly direction following the southern kerbline for 20.5 metres.</i>

g) GIVE WAY AND NO STOPPING AT ALL TIMES - CASHMERE AVENUE – RAUMATI TERRACE – KHANDALLAH – (40-07)

Add to Schedule G (Give Way and Stop Controls) of the Traffic Restrictions Schedule.

<i>Column One</i>	<i>Column Two</i>	<i>Column Three</i>
<i>Raumati Terrace</i>	<i>Give Way.</i>	<i>Southbound, at its intersection with Cashmere Avenue.</i>

Add to Schedule D (No Stopping Restrictions) of the Traffic Restrictions Schedule.

<i>Column One</i>	<i>Column Two</i>	<i>Column Three</i>
<i>Raumati Terrace</i>	<i>No Stopping At All Times.</i>	<i>West side, commencing at its intersection with Cashmere Avenue and extending in a northerly direction following the western kerbline for 11 metres.</i>
<i>Raumati Terrace</i>	<i>No Stopping At All Times.</i>	<i>East side, commencing at its intersection with Cashmere Avenue and extending in a northerly direction following the eastern kerbline for 11 metres.</i>

h) GIVE WAY AND NO STOPPING AT ALL TIMES – CASHMERE AVENUE – STATION ROAD – DELHI CRESCENT – KHANDALLAH – (41-07)

Add to Schedule D (No Stopping Restrictions) of the Traffic Restrictions Schedule.

<i>Column One</i>	<i>Column Two</i>	<i>Column Three</i>
<i>Cashmere Avenue</i>	<i>No Stopping At All Times.</i>	<i>West side, commencing at its intersection with Delhi Crescent and extending in a southerly direction following the western kerbline for 20.5 metres.</i>
<i>Station Road</i>	<i>No Stopping At All Times.</i>	<i>West side, commencing at its intersection with Delhi Crescent and extending in a northerly direction following the western</i>

kerbline for 39 metres.

Add to Schedule G (Give Way and Stop Controls) of the Traffic Restrictions Schedule.

<i>Column One</i>	<i>Column Two</i>	<i>Column Three</i>
<i>Delhi Crescent</i>	<i>Give Way.</i>	<i>Westbound, at its intersection with Cashmere Avenue – Station Road.</i>

- i) P5, GIVE WAY AND BUS STOP AT ALL TIMES - CASHMERE AVENUE – KHANDALLAH – (42-07)***

Delete from Schedule B (Bus Stops) of the Traffic Restrictions Schedule.

<i>Column One</i>	<i>Column Two</i>	<i>Column Three</i>
<i>Cashmere Avenue</i>	<i>Bus Stop At All Times.</i>	<i>North side, commencing 35 metres east of its intersection with Ranui Crescent (east) and extending in an easterly direction following the northern kerbline for 12 metres.</i>

Add to Schedule A (Time Limited Parking) of the Traffic

Restrictions Schedule.

<i>Column One</i>	<i>Column Two</i>	<i>Column Three</i>
<i>Cashmere Avenue</i>	<i>P5, Monday - Friday, 8:00am - 9:30am, 2:30pm - 3:30pm.</i>	<i>Southwest side, commencing on the southeast side of its intersection with Ranui Crescent (southeast) and extending in a northwesterly direction following the southwestern</i>

kerbline for 24.5 metres.

Add to Schedule G (Give Way and Stop Controls) of the Traffic Restrictions Schedule.

<i>Column One</i> <i>Ranui Crescent</i>	<i>Column Two</i> <i>Give Way.</i>	<i>Column Three</i> <i>Southwest, at its intersection with Cashmere Avenue.</i>
--	--	---

Add to Schedule B (Bus Stops) of the Traffic Restrictions Schedule.

<i>Column One</i> <i>Cashmere Avenue</i>	<i>Column Two</i> <i>Bus Stop At All Times.</i>	<i>Column Three</i> <i>Northeast side, commencing 34.5 metres east of its intersection with Ranui Crescent (southeast) and extending in a southeasterly direction following the northeastern kerbline for 10 metres.</i>
<i>Cashmere Avenue</i>	<i>Bus Stop At All Times.</i>	<i>Southwest side, commencing 24.5 metres northwest of its intersection with Ranui Crescent (southeast) and extending in a northwesterly direction following the southwestern kerbline for 11 metres.</i>

- j) STOP AND NO STOPPING AT ALL TIMES - COCKAYNE ROAD – CLUTHA AVENUE – KHANDALLAH – (43-07)***

Delete from Schedule D (No Stopping Restrictions) of the Traffic Restrictions Schedule.

<i>Column One</i> <i>Clutha Avenue</i>	<i>Column Two</i> <i>No Stopping At</i>	<i>Column Three</i> <i>South side,</i>
---	---	--

	<i>All Times.</i>	<i>commencing from its intersection with Cockayne Road and extending in an easterly direction following the southern kerbline to its intersection with Khandallah Road.</i>
<i>Clutha Avenue</i>	<i>No Stopping At All Times.</i>	<i>North side, commencing 2 metres north of its intersection with Cockayne Road and extending in an easterly direction following the northern kerbline for 8 metres.</i>

Add to Schedule D (No Stopping Restrictions) of the Traffic Restrictions Schedule.

<i>Column One</i>	<i>Column Two</i>	<i>Column Three</i>
<i>Clutha Avenue</i>	<i>No Stopping At All Times.</i>	<i>North side, commencing at its intersection with Cockayne Road and extending in an easterly direction following the northern kerbline for 35.5 metres.</i>
<i>Clutha Avenue</i>	<i>No Stopping At All Times.</i>	<i>South side, commencing at its intersection with Cockayne Road and extending in an easterly direction following the southern kerbline for 26.5 metres.</i>

Add to Schedule G (Give Way and Stop Controls) of the Traffic Restrictions Schedule.

<i>Column One</i> <i>Clutha Avenue</i>	<i>Column Two</i> <i>Stop.</i>	<i>Column Three</i> <i>Eastbound, at its intersection with Cockayne Road.</i>
---	-----------------------------------	--

- k) ***NO STOPPING AT ALL TIMES AND GIVE WAY - CASHMERE AVENUE – IZARD ROAD – KHANDALLAH – (44-07)***

Add to Schedule D (No Stopping Restrictions) of the Traffic Resolutions Schedule.

<i>Column One</i> <i>Izard Road</i>	<i>Column Two</i> <i>No Stopping At All Times.</i>	<i>Column Three</i> <i>West side, commencing at its intersection with Cashmere Avenue and extending in a southerly direction following the western kerb line for 27.5 metres.</i>
<i>Izard Road</i>	<i>No Stopping At All Times.</i>	<i>East side, commencing at its intersection with Cashmere Avenue and extending in a southerly direction following the eastern kerb line for 19.5 metres.</i>

Add to Schedule G (Give Way and Stop Controls) of the Traffic Restrictions Schedule.

<i>Column One</i> <i>Izard Road</i>	<i>Column Two</i> <i>Give Way.</i>	<i>Column Three</i> <i>Northbound, at its intersection with Cashmere Avenue.</i>
---	---------------------------------------	---

- l) ***STOP AND NO STOPPING AT ALL TIMES - COCKAYNE ROAD – PUNJAB STREET – NGAIO – (45-07)***

Add to Schedule D (No Stopping Restrictions) of the Traffic Restrictions Schedule.

<i>Column One</i> <i>Punjab Street</i>	<i>Column Two</i> <i>No Stopping At</i>	<i>Column Three</i> <i>West side,</i>
---	--	--

	<i>All Times.</i>	<i>commencing at its intersection with Cockayne Road and extending in a southerly direction following the western kerbline for 19 metres.</i>
<i>Punjab Street</i>	<i>No Stopping At All Times.</i>	<i>East side, commencing at its intersection with Cockayne Road and extending in a southerly direction following the eastern kerbline for 11.5 metres.</i>

Add to Schedule G (Give Way and Stop Controls) of the Traffic Restrictions Schedule.

<i>Column One Punjab Street</i>	<i>Column Two Stop.</i>	<i>Column Three Northbound, at its intersection with Cockayne Road.</i>
-------------------------------------	-----------------------------	---

- m) GIVE WAY AND NO STOPPING AT ALL TIMES - AGRA CRESCENT – NICHOLSON ROAD – KHANDALLAH – (46-07)*

Add to Schedule D (No Stopping Restrictions) of the Traffic Restrictions Schedule.

<i>Column One Agra Crescent</i>	<i>Column Two No Stopping At All Times.</i>	<i>Column Three North side, commencing at its intersection with Nicholson Road and extending in an easterly direction following the northern kerbline for 29 metres.</i>
-------------------------------------	---	--

<i>Agra Crescent</i>	<i>No Stopping At All Times.</i>	<i>South side, commencing at its intersection with Nicholson Road and extending in an easterly direction following the southern kerbline for 26.5 metres.</i>
----------------------	---	--

Add to Schedule G (Give Way and Stop Controls) of the Traffic Restrictions Schedule.

<i>Column One</i> <i>Agra Crescent</i>	<i>Column Two</i> <i>Give Way.</i>	<i>Column Three</i> <i>Westbound, at its intersection with Nicholson Road.</i>
---	--	--

- n) ***GIVE WAY AND NO STOPPING AT ALL TIMES - MYSORE STREET – COCKAYNE ROAD – KHANDALLAH – (47-07)***

Add to Schedule G (Give Way and Stop Controls) of the Traffic Restrictions Schedule.

<i>Column One</i> <i>Mysore Street</i>	<i>Column Two</i> <i>Give Way.</i>	<i>Column Three</i> <i>Southbound, at its intersection with Cockayne Road.</i>
---	--	--

Add to Schedule D (No Stopping Restrictions) of the Traffic Restrictions Schedule.

<i>Column One</i> <i>Mysore Street</i>	<i>Column Two</i> <i>No Stopping At All Times.</i>	<i>Column Three</i> <i>West side, commencing at its intersection with Cockayne Road and extending in a northerly direction following the western kerbline for 11.5</i>
---	--	--

<i>Mysore Street</i>	No Stopping At All Times.	<i>metres. East side, commencing at its intersection with Cockayne Road and extending in a northerly direction following the eastern kerbline for 18.5 metres.</i>
----------------------	----------------------------------	--

o) GIVE WAY AND NO STOPPING AT ALL TIMES - COCKAYNE ROAD – BANKOT CRESCENT – NGAIO – (48-07)

Add to Schedule G (Give Way and Stop Controls) of the Traffic Restrictions Schedule.

<i>Column One Bankot Crescent</i>	<i>Column Two Give Way.</i>	<i>Column Three Southbound, at its intersection with Cockayne Road.</i>
---------------------------------------	---------------------------------	---

Add to Schedule D (No Stopping Restrictions) of the Traffic Restrictions Schedule.

<i>Column One Bankot Crescent</i>	<i>Column Two No Stopping At All Times.</i>	<i>Column Three West side, commencing at its intersection with Cockayne Road and extending in a northerly direction following the western kerbline for 13.5 metres.</i>
<i>Bankot Crescent</i>	<i>No Stopping At All Times.</i>	<i>East side, commencing at its intersection with Cockayne Road and extending in a northerly direction following the eastern kerbline for 23.5 metres.</i>

p) GIVE WAY AND NO STOPPING AT ALL TIMES - BOMBAY STREET – COLWAY STREET – NGAIO – (49-07)

Add to Schedule G (Give Way and Stop Controls) of the Traffic Restrictions Schedule.

<i>Column One</i>	<i>Column Two</i>	<i>Column Three</i>
<i>Bombay Street</i>	<i>Give Way.</i>	<i>Eastbound, at its intersection with Colway Street.</i>
<i>Bombay Street</i>	<i>Give Way.</i>	<i>Westbound, at its intersection with Colway Street.</i>

Add to Schedule D (No Stopping Restrictions) of the Traffic Restrictions Schedule.

<i>Column One</i>	<i>Column Two</i>	<i>Column Three</i>
<i>Colway Street</i>	<i>No Stopping At All Times.</i>	<i>West side, commencing at its intersection with Bombay Street and extending in a northerly direction following the western kerbline for 25 metres.</i>
<i>Colway Street</i>	<i>No Stopping At All Times.</i>	<i>East side, commencing at its intersection with Bombay Street and extending in a northerly direction following the eastern kerbline for 30 metres.</i>
<i>Bombay Street</i>	<i>No Stopping At All Times.</i>	<i>South side, commencing at its intersection with Colway Street and extending in a westerly direction following the southern kerbline for 18.5 metres.</i>
<i>Bombay Street</i>	<i>No Stopping At All Times.</i>	<i>South side, commencing at its intersection with Colway Street and extending in an</i>

*easterly direction
following the
southern kerbline for
14 metres.*

- q) GIVE WAY AND NO STOPPING AT ALL TIMES - BOMBAY STREET – SWANSEA STREET – NGAIO – (50-07)**

Add to Schedule G (Give Way and Stop Controls) of the Traffic Restrictions Schedule.

<i>Column One</i>	<i>Column Two</i>	<i>Column Three</i>
<i>Bombay Street</i>	<i>Give Way.</i>	<i>Southeast, at its intersection with Mysore Street and Swansea Street.</i>
<i>Mysore Street</i>	<i>Give Way</i>	<i>Northbound, at its intersection with Bombay Street and Swansea Street.</i>
<i>Swansea Street</i>	<i>Give Way.</i>	<i>Southwest, at its intersection with Bombay Street and Mysore Street.</i>

Add to Schedule D (No Stopping Restrictions) of the Traffic Restrictions Schedule.

<i>Column One</i>	<i>Column Two</i>	<i>Column Three</i>
<i>Bombay Street</i>	<i>No Stopping At All Times.</i>	<i>Southwest side, commencing at its intersection with Mysore Street and extending in a northwesterly direction following the southwestern kerbline for 16 metres.</i>
<i>Bombay Street</i>	<i>No Stopping At All Times.</i>	<i>Northeast side, commencing at its intersection with Swansea Street and extending in a northwesterly</i>

<i>Mysore Street</i>	<i>No Stopping At All Times.</i>	<i>direction following the northeastern kerbline for 8.5 metres. West side, commencing at its intersection with Bombay Street and extending in a southerly direction following the western kerbline for 14.5 metres.</i>
<i>Swansea Street</i>	<i>No Stopping At All Times.</i>	<i>Northwest side, commencing at its intersection with Bombay Street and extending in a northeasterly direction following the northwestern kerbline for 26.5 metres.</i>
<i>Swansea Street</i>	<i>No Stopping At All Times.</i>	<i>Southeast side, commencing at its intersection with Mysore Street and extending in a northeasterly direction following the southeastern kerbline for 23 metres.</i>

r) GIVE WAY AND NO STOPPING AT ALL TIMES - ABBOTT STREET – IMLAY CRESCENT – NGAIO – (51-07)

Add to Schedule G (Give Way and Stop Controls) of the Traffic Restrictions Schedule.

<i>Column One Imlay Crescent</i>	<i>Column Two Give Way.</i>	<i>Column Three Northbound, at its intersection with</i>
--------------------------------------	---------------------------------	--

Abbott Street.

Add to Schedule D (No Stopping Restrictions) of the Traffic Restrictions Schedule.

<i>Column One</i>	<i>Column Two</i>	<i>Column Three</i>
<i>Imlay Crescent</i>	<i>No Stopping At All Times.</i>	<i>West side, commencing at its intersection with Abbott Street and extending in a southerly direction following the western kerbline for 16.5 metres.</i>
<i>Imlay Crescent</i>	<i>No Stopping At All Times.</i>	<i>East side, commencing at its intersection with Abbott Street and extending in a southerly direction following the eastern kerbline for 20.5 metres.</i>

- s) ***GIVE WAY AND NO STOPPING AT ALL TIMES - BENGAL STREET – CALCUTTA STREET – KHANDALLAH – (52-07)***

Add to Schedule G (Give Way and Stop controls) of the Traffic Restrictions Schedule.

<i>Column One</i>	<i>Column Two</i>	<i>Column Three</i>
<i>Bengal Street</i>	<i>Give Way.</i>	<i>Eastbound, at its intersection with Calcutta Street.</i>

Add to Schedule D (No Stopping Restrictions) of the Traffic Restrictions Schedule.

<i>Column One</i> Bengal Street	<i>Column Two</i> <i>No Stopping At All Times.</i>	<i>Column Three</i> <i>North side, commencing at its intersection with Calcutta Street and extending in a westerly direction following the northern kerbline for 17.5 metres.</i>
Bengal Street	<i>No Stopping At All Times.</i>	<i>South side, commencing at its intersection with Calcutta Street and extending in a westerly direction following the southern kerbline for 17.5 metres.</i>

t) **GIVE WAY AND NO STOPPING AT ALL TIMES - JUBILEE ROAD – CALCUTTA STREET – KHANDALLAH – (53-07)**

Add to Schedule D (No Stopping Restrictions) of the Traffic Restrictions Schedule.

<i>Column One</i> Jubilee Road	<i>Column Two</i> <i>No Stopping At All Times.</i>	<i>Column Three</i> <i>West side, commencing at its intersection with Calcutta Street and extending in a northerly direction following the western kerbline for 11.5 metres.</i>
Waru Street	<i>No Stopping At All Times.</i>	<i>West side, commencing at its intersection with Calcutta Street and extending in a southerly direction following the western kerbline for 27.5</i>

Waru Street	<i>No Stopping At All Times.</i>	<i>metres. East side, commencing at its intersection with Calcutta Street and extending in a southerly direction following the eastern kerbline for 20 metres.</i>
Calcutta Street	<i>No Stopping At All Times.</i>	<i>South side, commencing at its intersection with Waru Street and extending in a westerly direction following the southern kerbline for 17.5 metres.</i>
Calcutta Street	<i>No Stopping At All Times.</i>	<i>North side, commencing 6.5 metres from its intersection with Jubilee Road and extending in a westerly direction following the northern kerbline for 15.5 metres.</i>

Add to Schedule G (Give Way and Stop Controls) of the Traffic Restrictions Schedule.

Column One Jubilee Road	Column Two Give Way.	Column Three Southbound, at its intersection with Calcutta Street.
Waru Street	Give Way.	Northbound, at its intersection with Calcutta Street.

- u) **STOP, GIVE WAY AND NO STOPPING AT ALL TIMES - JUBILEE ROAD – NICHOLSON ROAD – KHANDALLAH – (54-07)**

Add to Schedule D (No Stopping Restrictions) of the Traffic Restrictions Schedule.

<i>Column One</i>	<i>Column Two</i>	<i>Column Three</i>
<i>Jubilee Road</i>	<i>No Stopping At All Times.</i>	<i>West side, commencing at its intersection with Nicholson Road and extending in a southerly direction following the western kerbline for 12.5 metres.</i>
<i>Jubilee Road</i>	<i>No Stopping At All Times.</i>	<i>West side, commencing at its intersection with Nicholson Road and extending in a northerly direction following the western kerbline for 17.5 metres.</i>
<i>Jubilee Road</i>	<i>No Stopping At All Times.</i>	<i>East side, commencing at its intersection with Nicholson Road and extending in a northerly direction following the eastern kerbline for 14 metres.</i>
<i>Jubilee Road</i>	<i>No Stopping At All Times.</i>	<i>East side, commencing at its intersection with Nicholson Road and extending in a southerly direction following the eastern kerbline for 14 metres.</i>

Add to Schedule G (Give Way and Stop Controls) of the Traffic Restrictions Schedule.

<i>Column One</i> Jubilee Road	<i>Column Two</i> Stop.	<i>Column Three</i> Northbound, at its intersection with Nicholson Road.
Jubilee Road	Give Way.	Southbound, at its intersection with Nicholson Road.

- v) **GIVE WAY AND NO STOPPING AT ALL TIMES - IZARD ROAD – EVEREST STREET – KHANDALLAH – (55-07)**

Delete from Schedule D (No Stopping Restrictions) of the Traffic Restrictions Schedule.

<i>Column One</i> Izard Road	<i>Column Two</i> No Stopping At All Times.	<i>Column Three</i> South side, commencing from its intersection with Everest Street and extending in a westerly direction following the southern kerbline for 12 metres.
Everest Street	No Stopping At All Times.	East side, commencing from its intersection with Izard Road and extending in a southerly direction following the eastern kerbline for 19 metres.
Ranui Crescent	No Stopping At All Times.	North side, commencing from its intersection with Izard Road and extending in an easterly direction following the northern kerbline for 15.5 metres.

Add to Schedule D (No Stopping Restrictions) of the Traffic Restrictions Schedule.

<i>Column One</i> Izard Road	<i>Column Two</i> No Stopping At	<i>Column Three</i> East side,
--	-------------------------------------	-----------------------------------

	<i>All Times.</i>	<i>commencing at its intersection with Ranui Crescent and extending in a northerly direction following the eastern kerbline for 27.5 metres.</i>
<i>Ranui Crescent</i>	<i>No Stopping At All Times.</i>	<i>North side, commencing at its intersection with Iazard Road and extending in an easterly direction following the northern kerbline for 6 metres.</i>
<i>Iazard Road</i>	<i>No Stopping At All Times.</i>	<i>West side, commencing at its intersection with Everest Street and extending in a northerly direction following the western kerbline for 27.5 metres.</i>
<i>Iazard Road</i>	<i>No Stopping At All Times.</i>	<i>West side, commencing at its intersection with Everest Street and extending in a southerly direction following the western kerbline for 22 metres.</i>
<i>Iazard Road</i>	<i>No Stopping At All Times.</i>	<i>East side, commencing at its intersection with Ranui Crescent and extending in a southerly direction following the eastern kerbline for 16 metres.</i>
<i>Everest Street</i>	<i>No Stopping At All Times.</i>	<i>South side, commencing at its intersection with Iazard Road and</i>

<i>Ranui Crescent</i>	<i>No Stopping At All Times.</i>	<i>extending in a westerly direction following the southern kerbline for 24.5 metres. South side, commencing at its intersection with Izard Road and extending in an easterly direction following the southern kerbline for 5 metres.</i>
------------------------------	---	---

Add to Schedule G (Give Way and Stop Controls) of the Traffic Restrictions Schedule.

<i>Column One Izard Road</i>	<i>Column Two Give Way.</i>	<i>Column Three Southbound, at its intersection with Ranui Crescent.</i>
<i>Izard Road</i>	<i>Give Way.</i>	<i>Northbound, at its intersection with Everest Street.</i>

- w) ***GIVE WAY - PUNJAB STREET – KABUL STREET –NGAIO – (56-07)***

Delete from Schedule D (No Stopping Restrictions) of the Traffic Restrictions Schedule.

<i>Column One Kabul Street</i>	<i>Column Two No Stopping At All Times.</i>	<i>Column Three West side, commencing from its intersection with Punjab Street and extending in a southerly direction following the western kerbline for 97 metres into a cul-de-sac.</i>
<i>Kabul Street</i>	<i>No Stopping At</i>	<i>East side,</i>

All Times. ***commencing from its intersection with Punjab Street and extending in a southerly direction following the eastern kerbline for 12 metres into a cul-de-sac.***

Add to Schedule D (No Stopping Restrictions) of the Traffic Restrictions Schedule.

<i>Column One</i>	<i>Column Two</i>	<i>Column Three</i>
<i>Kabul Street</i>	<i>No Stopping At All Times.</i>	<i>North side, commencing at its intersection with Punjab Street and extending in a westerly direction following the northern kerbline for 25.5 metres.</i>
<i>Kabul Street</i>	<i>No Stopping At All Times.</i>	<i>South side, commencing at its intersection with Punjab Street and extending in a westerly direction following the southern kerbline for 18.5 metres.</i>

Add to Schedule G (Give Way and Stop Controls) of the Traffic Restrictions Schedule.

<i>Column One</i>	<i>Column Two</i>	<i>Column Three</i>
<i>Kabul Street</i>	<i>Give Way.</i>	<i>Eastbound, at its intersection with Punjab Street.</i>

- x) ***GIVE WAY AND NO STOPPING AT ALL TIMES - DEKKA STREET – NICHOLSON ROAD – KHANDALLAH – (57-07)***

Add to Schedule D (No Stopping Restrictions) of the Traffic Restrictions Schedule.

<i>Column One</i>	<i>Column Two</i>	<i>Column Three</i>
<i>Nicholson Road</i>	<i>No Stopping At All Times.</i>	<i>West side, commencing at its intersection with Clutha Avenue and extending in a northerly direction following the southwestern kerbline for 16.5 metres.</i>
<i>Nicholson Road</i>	<i>No Stopping At All Times.</i>	<i>East side, commencing at its intersection with Dekka Street and extending in a northerly direction following the northeastern kerbline for 18.5 metres.</i>
<i>Nicholson Road</i>	<i>No Stopping At All Times.</i>	<i>Southwest side, commencing at its intersection with Clutha Avenue and extending in a southeasterly direction following the southwestern kerbline for 26.5 metres.</i>
<i>Nicholson Road</i>	<i>No Stopping At All Times.</i>	<i>Northeast side, commencing at its intersection with Dekka Street and extending in a southeasterly direction following the northeastern kerbline for 22 metres.</i>
<i>Clutha Avenue</i>	<i>No Stopping At All Times.</i>	<i>North side, commencing at its</i>

		<i>intersection with Nicholson Road and extending in a westerly direction following the northern kerbline for 15.5 metres.</i>
<i>Column One Clutha Avenue</i>	<i>Column Two No Stopping At All Times.</i>	<i>Column Three South side, commencing at its intersection with Nicholson Road and extending in a westerly direction following the southern kerbline for 7.5 metres.</i>
<i>Dekka Street</i>	<i>No Stopping At All Times.</i>	<i>North side, commencing at its intersection with Nicholson Road and extending in an easterly direction following the northern kerbline for 7 metres.</i>
<i>Dekka Street</i>	<i>No Stopping At All Times.</i>	<i>South side, commencing at its intersection with Nicholson Road and extending in an easterly direction following the southern kerbline for 13 metres.</i>

*Add to Schedule G (Give Way and Stop Controls) of the Traffic
Restrictions Schedule.*

<i>Column One Nicholson Road</i>	<i>Column Two Give Way.</i>	<i>Column Three Northwest bound at its intersection with Clutha Avenue.</i>
<i>Nicholson Road</i>	<i>Give Way.</i>	<i>Southeast bound, at its intersection with Dekka Street.</i>

- y) **STOP, NO STOPPING AT ALL TIMES, P15 AND P60 - COLWAY STREET – KHANDALLAH ROAD – KHANDALLAH – (58-07)**

Delete from Schedule A (Time Limited Parking) of the Traffic Restrictions Schedule.

<i>Column One</i>	<i>Column Two</i>	<i>Column Three</i>
Colway Street	P15 At All Times.	North side, commencing 10 metres east of its intersection with Khandallah Road and extending in an easterly direction following the northern kerbline for 17 metres.
Colway Street	P60, Monday - Friday, 8:00am - 6:00pm.	North side, commencing 27 metres east of its intersection with Khandallah Road and extending in an easterly direction following the northern kerbline for 12 metres.

Add to Schedule D (No Stopping Restrictions) of the Traffic Restrictions Schedule.

<i>Column One</i>	<i>Column Two</i>	<i>Column Three</i>
Colway Street	No Stopping At All Times.	North side, commencing at its intersection with Khandallah Road and extending in an easterly direction following the northern kerbline for 20.5 metres.
Colway Street	No Stopping At All Times.	South side, commencing at its intersection with Khandallah Road

and extending in an easterly direction following the southern kerbline for 38.5 metres.

Add to Schedule A (Time Limited Parking) of the Traffic

Restrictions Schedule.

<i>Column One</i> <i>Colway Street</i>	<i>Column Two</i> <i>P15 At All Times.</i>	<i>Column Three</i> <i>North side, 20.5 metres from its intersection with Khandallah Road and extending in an easterly direction following the northern kerbline for 12 metres.</i>
<i>Colway Street</i>	<i>P60, Monday - Friday, 8:00am - 6:00pm.</i>	<i>North side 32.5 metres from its intersection with Khandallah Road and extending in an easterly direction following the northern kerbline for 6.5 metres.</i>

Add to Schedule G (Give Way and Stop Controls) of the Traffic Restrictions Schedule.

<i>Column One</i> <i>Colway Street</i>	<i>Column Two</i> <i>Stop.</i>	<i>Column Three</i> <i>Westbound, at its intersection with Khandallah Road.</i>
--	--	---

- z) ***GIVE WAY AND NO STOPPING AT ALL TIMES - LUCKNOW TERRACE – COCKAYNE ROAD – KHANDALLAH – (59-07)***

Add to Schedule D (No Stopping Restrictions) of the Traffic Restrictions Schedule.

<i>Column One</i> <i>Lucknow Terrace</i>	<i>Column Two</i> <i>No Stopping At All Times.</i>	<i>Column Three</i> <i>North side, commencing at its</i>
--	--	--

<i>Lucknow Terrace</i>	<i>No Stopping At All Times.</i>	<i>intersection with Cockayne Road and extending in a westerly direction following the northern kerbline for 18.5 metres. South side, commencing at its intersection with Cockayne Road and extending in a westerly direction following the southern kerbline for 80 metres.</i>
<i>Cockayne Road</i>	<i>No Stopping At All Times.</i>	<i>West side, commencing at its intersection with Lucknow Terrace and extending in a southerly direction following the western kerbline for 3 metres.</i>
<i>Lucknow Terrace</i>	<i>No Stopping At All Times.</i>	<i>North side, commencing 35.5 metres from its intersection with Cockayne Road and extending in a westerly direction following the northern kerbline for 43 metres.</i>

Add to Schedule G (Give Way and Stop Controls) of the Traffic Restrictions Schedule.

<i>Column One</i>	<i>Column Two</i>	<i>Column Three</i>
<i>Lucknow Terrace</i>	<i>Give Way.</i>	<i>Eastbound, at its intersection with Cockayne Road.</i>

aa) GIVE WAY AND NO STOPPING AT ALL TIMES - PERTH STREET – CROFTON ROAD – NGAIO – (60-07)

Add to Schedule G (Give Way and Stop Controls) of the Traffic Restrictions Schedule.

<i>Column One</i> Crofton Road	<i>Column Two</i> Give Way.	<i>Column Three</i> Southbound, at its intersection with Perth Street.
--	--------------------------------	---

Add to Schedule D (No Stopping Restrictions) of the Traffic Restrictions Schedule.

<i>Column One</i> Crofton Road	<i>Column Two</i> No Stopping At All Times.	<i>Column Three</i> West side, commencing at its intersection with Perth Street and extending in a northerly direction following the western kerbline for 9.5 metres.
Crofton Road	No Stopping At All Times.	East side, commencing at its intersection with Cockayne Road and extending in a northerly direction following the eastern kerbline for 32 metres.
Perth Street	No Stopping At All Times.	North side, commencing at its intersection with Crofton Road and extending in a westerly direction following the northern kerbline for 7.5 metres.

bb) GIVE WAY AND NO STOPPING AT ALL TIMES - COCKAYNE ROAD – ELLORA STREET – NGAIO – (61-07)

Delete from Schedule D (No Stopping Restrictions) of the Traffic Restrictions Schedule.

<i>Column One</i>	<i>Column Two</i>	<i>Column Three</i>
<i>Ellora Street</i>	<i>No Stopping At All Times.</i>	<i>West side, commencing at its intersection with Cockayne Road and extending in a southerly direction following the western kerbline for 12.5 metres.</i>
<i>Ellora Street</i>	<i>No Stopping At All Times.</i>	<i>East side, commencing at its intersection with Cockayne Road and extending in a southerly direction following the eastern kerbline for 9 metres.</i>

Add to Schedule D (No Stopping Restrictions) of the Traffic Restrictions Schedule.

<i>Column One</i>	<i>Column Two</i>	<i>Column Three</i>
<i>Ellora Street</i>	<i>No Stopping At All Times.</i>	<i>West side, commencing at its intersection with Cockayne Road and extending in a southerly direction following the western kerbline for 14.5 metres.</i>
<i>Ellora Street</i>	<i>No Stopping At All Times.</i>	<i>East side, commencing at its intersection with Cockayne Road and extending in a southerly direction following the eastern kerbline for 14 metres.</i>

Add to Schedule G (Give Way and Stop Controls) of the Traffic Restrictions Schedule.

<i>Column One</i>	<i>Column Two</i>	<i>Column Three</i>
<i>Ellora Street</i>	<i>Give Way.</i>	<i>Northbound, at its intersection with Cockayne Road.</i>

- cc) ***GIVE WAY AND NO STOPPING AT ALL TIMES - COCKAYNE ROAD – QUETTA STREET – NGAIO - (62-07)***

Add to Schedule D (No Stopping Restrictions) of the Traffic Restrictions Schedule.

<i>Column One</i>	<i>Column Two</i>	<i>Column Three</i>
<i>Quetta Street</i>	<i>No Stopping At All Times.</i>	<i>West side, commencing at its intersection with Cockayne Road and extending in a northerly direction following the western kerbline for 13 metres.</i>
<i>Quetta Street</i>	<i>No Stopping At All Times.</i>	<i>East side, commencing at its intersection with Cockayne Road and extending in a northerly direction following the eastern kerbline for 12.5 metres.</i>

Add to Schedule G (Give Way and Stop Controls) of the Traffic Restrictions Schedule.

<i>Column One</i>	<i>Column Two</i>	<i>Column Three</i>
<i>Quetta Street</i>	<i>Give Way.</i>	<i>Southbound, at its intersection with Cockayne Road.</i>

- dd) GIVE WAY AND NO STOPPING AT ALL TIMES - PUNJAB STREET – WARU STREET – NGAIO – (63-07)**

Add to Schedule G (Give Way and Stop Controls) of the Traffic Restrictions Schedule.

<i>Column One</i>	<i>Column Two</i>	<i>Column Three</i>
Waru Street	Give Way.	Northbound, at its intersection with Punjab Street.

Add to Schedule D (No Stopping Restrictions) of the Traffic Restrictions Schedule.

<i>Column One</i>	<i>Column Two</i>	<i>Column Three</i>
Waru Street	No Stopping At All Times.	West side, commencing at its intersection with Punjab Street and extending in a southerly direction following the western kerbline for 12 metres.
Waru Street	No Stopping At All Times.	East side, commencing at its intersection with Punjab Street and extending in a southerly direction following the eastern kerbline for 19 metres.

- ee) STOP AND NO STOPPING AT ALL TIMES - KENYA STREET – TRELISSICK CRESCENT – NGAIO – (64-07)**

Add to Schedule D (No Stopping Restrictions) of the Traffic Restrictions Schedule.

<i>Column One</i> <i>Trelissick Crescent</i>	<i>Column Two</i> No Stopping At All Times.	<i>Column Three</i> Southwest side, commencing 20 metres from its intersection with Kenya Street and extending in a northwesterly direction following the southwestern kerbline for 11.5 metres.
<i>Trelissick Crescent</i>	No Stopping At All Times.	Northeast side, commencing 6 metres from its intersection with Kenya Street and extending in a northwesterly direction following the northeastern kerbline for 14 metres.

Add to Schedule G (Give Way and Stop Controls) of the Traffic Restrictions Schedule.

<i>Column One</i> Trelissick Crescent	<i>Column Two</i> Stop.	<i>Column Three</i> Southeast bound, at its intersection with Kenya Street.
---	-----------------------------------	---

ff) NO STOPPING AT ALL TIMES - NGAIO GORGE ROAD – TRELISSICK CRESCENT – NGAIO – (65-07)

Add to Schedule D (No Stopping Restrictions) of the Traffic Restrictions Schedule.

<i>Column One</i> <i>Trelissick Crescent</i>	<i>Column Two</i> No Stopping At All Times.	<i>Column Three</i> Northwest side, commencing at its intersection with
---	---	---

<i>Trelissick Crescent</i>	<i>No Stopping At All Times.</i>	<i>Ngaio Gorge Road and extending in a southwesterly direction following the northwestern kerbline for 24.5 metres. Southeast side, commencing at its intersection with Ngaio Gorge Road and extending in a southwesterly direction following the southeastern kerbline for 24.5 metres.</i>
----------------------------	---	---

gg) STOP - SWANSEA STREET – LUCKNOW TERRACE – NGAIO – (66-07)

Delete from Schedule G (Give Way and Stop Controls) of the Traffic Restrictions Schedule.

<i>Column One</i>	<i>Column Two</i>	<i>Column Three</i>
<i>Swansea Street</i>	<i>Stop.</i>	<i>Swansea Street, at its southern approach to its intersection with Lucknow Terrace.</i>

Add to Schedule G (Give Way and Stop Controls) of the Traffic Restrictions Schedule.

<i>Column One</i>	<i>Column Two</i>	<i>Column Three</i>
<i>Swansea Street</i>	<i>Stop.</i>	<i>Eastbound, at its intersection with Lucknow Terrace.</i>

hh) GIVE WAY - SWANSEA STREET – NGATOTO STREET – NGAIO – (67-07)

Add to Schedule G (Give Way and Stop Controls) of the Traffic Restrictions Schedule.

<i>Column One</i>	<i>Column Two</i>	<i>Column Three</i>
Ngatoto Street	Give Way.	Northwest bound, at its intersection with Swansea Street.
Ngatoto Street	Give Way	Southeast bound, at its intersection with Swansea Street.

ii) NO STOPPING AT ALL TIMES - APLIN TERRACE – BOMBAY STREET – NGAIO – (68-07)

Add to Schedule D (No Stopping Restrictions) of the Traffic Restrictions Schedule.

<i>Column One</i>	<i>Column Two</i>	<i>Column Three</i>
Bombay Street	No Stopping At All Times.	North side, commencing at its intersection with Aplin Terrace and extending in a westerly direction following the northern kerbline for 4.5 metres.
Bombay Street	No Stopping At All Times.	South side, commencing at its intersection with Aplin Terrace and extending in a westerly direction following the southern kerbline for 17 metres.
Aplin Terrace	No Stopping At All Times.	West side, commencing at its intersection with Bombay Street and extending in a northerly direction following the western

<i>Aplin Terrace</i>	<i>No Stopping At All Times.</i>	<i>kerbline for 10.5 metres. East side, commencing at its intersection with Bombay Street and extending in a northerly direction following the eastern kerbline for 16 metres.</i>
----------------------	---	---

jj) STOP, GIVE WAY AND NO STOPPING AT ALL TIMES - BOX HILL – STATION ROAD – KHANDALLAH – (69-07)

Add to Schedule D (No Stopping Restrictions) of the Traffic Restrictions Schedule.

<i>Column One</i>	<i>Column Two</i>	<i>Column Three</i>
<i>Station Road</i>	<i>No Stopping At All Times.</i>	<i>South side, commencing at its intersection with Box Hill and extending in an easterly direction following the southern kerbline for 15 metres.</i>
<i>Baroda Street</i>	<i>No Stopping At All Times.</i>	<i>North side, commencing at its intersection with Box Hill and extending in a westerly direction following the northern kerbline for 15 metres.</i>
<i>Box Hill</i>	<i>No Stopping At All Times.</i>	<i>West side, commencing at its intersection with Baroda Street and extending in a northerly direction following the western kerbline for 18 metres.</i>

<i>Box Hill</i>	<i>No Stopping At All Times.</i>	<i>East side, commencing at its intersection with Station Road and extending in a southerly direction following the eastern kerbline for 8 metres.</i>
-----------------	----------------------------------	--

Add to Schedule G (Give Way and Stop Controls) of the Traffic Restrictions Schedule.

<i>Column One</i> <i>Station Road</i>	<i>Column Two</i> <i>Stop.</i>	<i>Column Three</i> <i>Westbound, at its intersection with Box Hill.</i>
<i>Baroda Street</i>	<i>Give Way.</i>	<i>Eastbound, at its intersection with Box Hill.</i>

kk) NO STOPPING AT ALL TIMES - GANGES ROAD – EVEREST STREET – KHANDALLAH – (70-07)

Delete from Schedule D (No Stopping Restrictions) of the Traffic Restrictions Schedule.

<i>Column One</i> <i>Ganges Road</i>	<i>Column Two</i> <i>No Stopping At All Times.</i>	<i>Column Three</i> <i>West side, commencing at its intersection with Everest Street and extending in a northerly direction for 13 metres.</i>
--	---	---

Add to Schedule D (No Stopping Restrictions) of the Traffic Restrictions Schedule.

<i>Column One</i>	<i>Column Two</i>	<i>Column Three</i>
-------------------	-------------------	---------------------

<i>Ganges Road</i>	<i>No Stopping At All Times.</i>	<i>West side, commencing at its intersection with Everest Street and extending in a northerly direction following the western kerbline for 28 metres.</i>
<i>Ganges Road</i>	<i>No Stopping At All Times.</i>	<i>East side, commencing at its intersection with Everest Street and extending in a northerly direction following the eastern kerbline for 24 metres.</i>
<i>Everest Street</i>	<i>No Stopping At All Times.</i>	<i>North side, commencing at its intersection with Ganges Road and extending in a westerly direction following the northern kerbline for 15.5 metres.</i>
<i>Everest Street</i>	<i>No Stopping At All Times.</i>	<i>North side, commencing at its intersection with Ganges Road and extending in an easterly direction following the northern kerbline for 14.5 metres.</i>
<i>Everest Street</i>	<i>No Stopping At All Times.</i>	<i>South side, opposite its intersection with Ganges Road, extending in an easterly direction following the southern kerbline for 15.5 metres.</i>

**ll) GIVE WAY AND NO STOPPING AT ALL TIMES -
HOMEBUSH ROAD – BENARES STREET –
KHANDALLAH – (71-07)**

Add to Schedule D (No Stopping Restrictions) of the Traffic Restrictions Schedule.

<i>Column One</i>	<i>Column Two</i>	<i>Column Three</i>
<i>Benares Street</i>	<i>No Stopping At All Times.</i>	<i>West side, commencing at its intersection with Homebush Road and extending in a southerly direction following the western kerbline for 26.5 metres.</i>
<i>Benares Street</i>	<i>No Stopping At All Times.</i>	<i>East side, commencing at its intersection with Homebush Road and extending in a southerly direction following the eastern kerbline for 21 metres.</i>

Add to Schedule G (Give Way and Stop Controls) of the Traffic Restrictions Schedule.

<i>Column One</i>	<i>Column Two</i>	<i>Column Three</i>
<i>Benares Street</i>	<i>Give Way.</i>	<i>Northbound, at its intersection with Homebush Road.</i>

**mm) GIVE WAY AND NO STOPPING AT ALL TIMES -
SILVERSTREAM ROAD – CHURCHILL DRIVE – CROFTON
DOWNS – (72-07)**

Add to Schedule G (Give Way and Stop Controls) of the Traffic Restrictions Schedule.

<i>Column One</i>	<i>Column Two</i>	<i>Column Three</i>
Churchill Drive	<i>Give Way.</i>	<i>Northbound, at its intersection with Silverstream Road.</i>
Waikowhai Street	<i>Give Way.</i>	<i>Westbound, at its intersection with Silverstream Road.</i>
Silverstream Road	<i>Give Way.</i>	<i>Eastbound, at its intersection with Churchill Drive.</i>
Greater Wellington Regional Council Car Park Entrance	<i>Give Way.</i>	<i>Traffic leaving the Railway Station Car Park, entering the Churchill Drive / Silverstream Road roundabout.</i>

Add to Schedule D (No Stopping Restrictions) of the Traffic Restrictions Schedule.

<i>Column One</i>	<i>Column Two</i>	<i>Column Three</i>
Silverstream Road	<i>No Stopping At All Times.</i>	<i>South side, commencing at its intersection with Churchill Drive and extending in an easterly direction following the southern kerbline for 127 metres.</i>
Silverstream Road	<i>No Stopping At All Times.</i>	<i>North side, commencing at its intersection with Churchill Drive and extending in an easterly direction following the northern kerbline for 8 metres.</i>
Churchill Drive	<i>No Stopping At</i>	<i>East side,</i>

	<i>All Times.</i>	<i>commencing at its intersection with the Greater Wellington Regional Council Car Park entrance and extending in a southerly direction following the eastern kerblines for 11 metres.</i>
<i>Waikowhai Street</i>	<i>No Stopping At All Times.</i>	<i>North side, commencing at its intersection with Silverstream Road and extending in an easterly direction following the northern kerblines for 19 metres.</i>
<i>Waikowhai Street</i>	<i>No Stopping At All Times.</i>	<i>South side, commencing at its intersection with the Greater Wellington Regional Council Car Park entrance and extending in an easterly direction following the southern kerblines for 17 metres.</i>
<i>Greater Wellington Regional Council Car Park Entrance</i>	<i>No Stopping At All Times.</i>	<i>North and south side, commencing at its intersection with Churchill Drive and Waikowhai Street, extending in a westerly direction following the kerblines into the car park.</i>

nn) GIVE WAY - CHARTWELL DRIVE – CASSIS PLACE / DUNDEE PLACE – CHARTWELL – (73-07)

Add to Schedule G (Give Way and Stop Controls) of the Traffic Restrictions Schedule.

<i>Column One</i> Cassis Place	<i>Column Two</i> Give Way.	<i>Column Three</i> Southeast bound, at its intersection with Chartwell Drive.
Dundee Place	Give Way.	Northwest bound, at its intersection with Chartwell Drive.

- oo) **GIVE WAY AND NO STOPPING AT ALL TIMES - THATCHER CRESCENT – SILVERSTREAM ROAD – CROFTON DOWNS – (74-07)**

Add to Schedule D (No Stopping Restrictions) of the Traffic Resolutions Schedule.

<i>Column One</i> Thatcher Crescent	<i>Column Two</i> No Stopping At All Times.	<i>Column Three</i> East side, commencing at its intersection with Silverstream Road and extending in a northerly direction following the eastern kerbline for 27 metres.
Silverstream Road	No Stopping At All Times.	North side, commencing at its intersection with Thatcher Crescent and extending in a westerly direction following the northern kerbline for 7 metres.

Add to Schedule G (Give Way and Stop Controls) of the Traffic Restrictions Schedule.

<i>Column One</i>	<i>Column Two</i>	<i>Column Three</i>
Thatcher Crescent	Give Way.	Southbound, at its intersection with Silverstream Road.

pp) NO STOPPING AT ALL TIMES - WINSTON STREET – CHARTWELL DRIVE – CHARTWELL – (75-07)

Add to Schedule D (No Stopping Restrictions) of the Traffic Restrictions Schedule.

<i>Column One</i>	<i>Column Two</i>	<i>Column Three</i>
Winston Street	No Stopping At All Times.	North side, commencing at its intersection with Chartwell Drive and extending in a westerly direction following the northern kerbline for 21.5 metres.
Winston Street	No Stopping At All Times.	South side, commencing at its intersection with Chartwell Drive and extending in a westerly direction following the southern kerbline for 21 metres.

qq) NO STOPPING AT ALL TIMES - SILVERSTREAM ROAD – CROFTON DOWNS – (76-07)

Add to Schedule D (No Stopping Restrictions) of the Traffic Restrictions Schedule.

<i>Column One</i> <i>Silverstream Road</i>	<i>Column Two</i> No Stopping At All Times.	<i>Column Three</i> North side, commencing 145.5 metres from its western intersection with Spencer Street and extending in an easterly direction following the northern kerbline for 30 metres.
<i>Silverstream Road</i>	No Stopping At All Times.	South side, commencing 142.5 metres from its western intersection with Spencer Street and extending in an easterly direction following the southern kerbline for 30 metres.

- rr) GIVE WAY AND NO STOPPING AT ALL TIMES - WINSTON STREET – SPENCER STREET – CROFTON DOWNS – (77-07)**

Add to Schedule G (Give Way and Stop Controls) of the Traffic Restrictions Schedule.

<i>Column One</i> Winston Street	<i>Column Two</i> Give Way.	<i>Column Three</i> Northbound, at its intersection with Spencer Street.
--	--------------------------------	---

Add to Schedule D (No Stopping Restrictions) of the Traffic Restrictions Schedule.

<i>Column One</i> <i>Winston Street</i>	<i>Column Two</i> No Stopping At All Times.	<i>Column Three</i> West side, commencing at its intersection with Spencer Street and
--	---	---

<i>Winston Street</i>	<i>No Stopping At All Times.</i>	<i>extending in a southerly direction following the western kerbline for 52.5 metres. East side, commencing at its intersection with Spencer Street and extending in a southerly direction following the eastern kerbline for 33 metres.</i>
-----------------------	---	--

ss) ***NO STOPPING AT ALL TIMES - WINSTON STREET – CROFTON DOWNS – (78-07)***

Add to Schedule D (No Stopping Restrictions) of the Traffic Restrictions Schedule.

<i>Column One</i>	<i>Column Two</i>	<i>Column Three</i>
<i>Winston Street</i>	<i>No Stopping At All Times.</i>	<i>West side, commencing 31.5 metres from its intersection with Jerome Way and extending in a northerly direction following the western kerbline for 29 metres.</i>
<i>Winston Street</i>	<i>No Stopping At All Times.</i>	<i>East side, commencing 31.5 metres from its intersection with Jerome Way and extending in a northerly direction following the western kerbline for 29 metres.</i>

- tt) GIVE WAY - CHARTWELL DRIVE – DOWNING STREET – CHARTWELL - (79-07)**

Add to Schedule G (Give Way and Stop Controls) of the Traffic Restrictions Schedule.

<i>Column One</i>	<i>Column Two</i>	<i>Column Three</i>
<i>Downing Street</i>	<i>Give Way.</i>	<i>Southbound, at its intersection with Chartwell Drive.</i>

- uu) GIVE WAY - SATARA CRESCENT – KAPIL GROVE – NGAIO – (80-07)**

Add to Schedule G (Give Way and Stop Controls) of the Traffic Restrictions Schedule.

<i>Column One</i>	<i>Column Two</i>	<i>Column Three</i>
<i>Kapil Grove</i>	<i>Give Way.</i>	<i>Eastbound, at its intersection with Satara Crescent.</i>

- vv) GIVE WAY AND NO STOPPING AT ALL TIMES - SATARA CRESCENT – RAMPHAL TERRACE – NGAIO – (81-07)**

Add to Schedule G (Give Way and Stop Controls) of the Traffic Restrictions Schedule.

<i>Column One</i>	<i>Column Two</i>	<i>Column Three</i>
<i>Ramphal Terrace</i>	<i>Give Way.</i>	<i>Westbound, at its intersection with Satara Crescent.</i>

Add to Schedule D (No Stopping Restrictions) of the Traffic Restrictions Schedule.

<i>Column One</i>	<i>Column Two</i>	<i>Column Three</i>

Ramphal Terrace	<i>No Stopping At All Times.</i>	<i>North side, commencing at its intersection with Satara Crescent and extending in an easterly direction following the northern kerbline for 17.5 metres.</i>
Ramphal Terrace	<i>No Stopping At All Times.</i>	<i>South side, commencing at its intersection with Satara Crescent and extending in an easterly direction following the southern kerbline for 17 metres.</i>

ww) GIVE WAY AND NO STOPPING AT ALL TIMES - AMAPUR DRIVE - SATARA CRESCENT – NGAIO – (82-07)

Add to Schedule G (Give Way and Stop Controls) of the Traffic Restrictions Schedule.

<i>Column One</i>	<i>Column Two</i>	<i>Column Three</i>
Satara Crescent	<i>Give Way.</i>	<i>Southbound, at its intersection with Amapur Drive.</i>

Add to Schedule D (No Stopping Restrictions) of the Traffic Restrictions Schedule.

<i>Column One</i>	<i>Column Two</i>	<i>Column Three</i>
Satara Crescent	<i>No Stopping At All Times.</i>	<i>West side, commencing at its intersection with Amapur Drive and extending in a northerly direction following the western kerbline for 16.5 metres.</i>
Satara Crescent	<i>No Stopping At All Times.</i>	<i>East side, commencing at its intersection with</i>

Amapur Drive and extending in a northerly direction following the eastern kerbline for 15.5 metres.

xx) GIVE WAY AND NO STOPPING AT ALL TIMES - CLARK STREET – SIMLA CRESCENT – KHANDALLAH – (83-07)

Delete from Schedule D (No Stopping Restrictions) of the Traffic Restrictions Schedule.

<i>Column One</i>	<i>Column Two</i>	<i>Column Three</i>
<i>Simla Crescent</i>	<i>No Stopping At All Times.</i>	<i>West side, commencing from its intersection with Clark Street and extending in a northerly direction following the western kerbline for 11 metres.</i>
<i>Simla Crescent</i>	<i>No Stopping At All Times.</i>	<i>East side, commencing at its intersection with Clark Street and extending in a southerly direction following the eastern kerbline for 11 metres.</i>

Add to Schedule D (No Stopping Restrictions) of the Traffic Restrictions Schedule.

<i>Column One</i>	<i>Column Two</i>	<i>Column Three</i>
<i>Simla Crescent</i>	<i>No Stopping At All Times.</i>	<i>Northwest side, commencing at its intersection with Clark Street and extending in a southwesterly direction following the northwestern kerbline</i>

<i>Simla Crescent</i>	<i>No Stopping At All Times.</i>	<i>for 18 metres. Southeast side, commencing at its intersection with Clark Street and extending in a southwesterly direction following the southeastern kerbline for 15.5 metres.</i>
------------------------------	---	---

Add to Schedule G (Give Way and Stop Controls) of the Traffic Restrictions Schedule.

<i>Column One</i>	<i>Column Two</i>	<i>Column Three</i>
<i>Simla Crescent</i>	<i>Give Way.</i>	<i>Northeast bound, at its intersection with Clark Street.</i>

yy) ***GIVE WAY AND NO STOPPING AT ALL TIMES - FOX STREET – ROSALIND STREET – NGAIO – (84-07)***

Add to Schedule G (Give Way and Stop Controls) of the Traffic Restrictions Schedule.

<i>Column One</i>	<i>Column Two</i>	<i>Column Three</i>
<i>Rosalind Street</i>	<i>Give Way.</i>	<i>Westbound, at its intersection with Fox Street.</i>

Add to Schedule D (No Stopping Restrictions) of the Traffic Restrictions Schedule.

<i>Column One</i>	<i>Column Two</i>	<i>Column Three</i>
<i>Rosalind Street</i>	<i>No Stopping At All Times.</i>	<i>North side, commencing at its intersection with Fox Street and extending in an easterly direction following the northern kerbline for 24 metres.</i>
<i>Rosalind Street</i>	<i>No Stopping At All Times.</i>	<i>South side, commencing at its</i>

*intersection with
Fox Street and
extending in an
easterly direction
following the
southern kerblin
for 24 metres.*

zz) STOP AND NO STOPPING AT ALL TIMES - AWARUA STREET – FOX STREET – NGAIO – (85-07)

Add to Schedule D (No Stopping Restrictions) of the Traffic Restrictions Schedule.

<i>Column One</i>	<i>Column Two</i>	<i>Column Three</i>
<i>Fox Street</i>	<i>No Stopping At All Times.</i>	<i>West side, commencing at its intersection with Awarua Street and extending in a northerly direction following the western kerblin for 15.5 metres.</i>
<i>Fox Street</i>	<i>No Stopping At All Times.</i>	<i>East side, commencing at its intersection with Awarua Street and extending in a northerly direction following the eastern kerblin for 32 metres.</i>

Add to Schedule G (Give Way and Stop Controls) of the Traffic Restrictions Schedule.

<i>Column One</i>	<i>Column Two</i>	<i>Column Three</i>
<i>Fox Street</i>	<i>Stop.</i>	<i>Southbound, at its intersection with Awarua Street.</i>

aaa) GIVE WAY AND NO STOPPING AT ALL TIMES - ROTHESAY ROAD – AWARUA STREET – NGAIO – (86-07)

Delete from Schedule D (No Stopping Restrictions) of the Traffic Restrictions Schedule.

<i>Column One</i>	<i>Column Two</i>	<i>Column Three</i>
<i>Rothesay Road</i>	<i>No Stopping At All Times.</i>	<i>East side, commencing at its intersection with Awarua Street and extending in a southerly direction following the eastern kerbline for 16 metres.</i>

Add to Schedule G (Give Way and Stop Controls) of the Traffic Restrictions Schedule.

<i>Column One</i>	<i>Column Two</i>	<i>Column Three</i>
<i>Rothesay Road</i>	<i>Give Way.</i>	<i>Northbound, at its intersection with Awarua Street.</i>
<i>Awarua Street</i>	<i>Give Way.</i>	<i>Eastbound, at its intersection with Rothesay Road.</i>
<i>Awarua Street</i>	<i>Give Way.</i>	<i>Westbound, at its intersection with Rothesay Road.</i>

Add to Schedule D (No Stopping Restrictions) of the Traffic Restrictions Schedule.

<i>Column One</i>	<i>Column Two</i>	<i>Column Three</i>
<i>Rothesay Road</i>	<i>No Stopping At All Times.</i>	<i>West side, commencing at its intersection with Awarua Street and extending in a southerly direction following the western kerbline for 32 metres.</i>
<i>Rothesay Road</i>	<i>No Stopping At All Times.</i>	<i>East side, commencing at its intersection with</i>

<i>Awarua Street</i>	<i>No Stopping At All Times.</i>	<i>Awarua Street and extending in a southerly direction following the eastern kerbline for 27 metres. North side, commencing at its intersection with Rothesay Road and extending in a westerly direction following the northern kerbline for 20 metres.</i>
<i>Awarua Street</i>	<i>No Stopping At All Times.</i>	<i>North side, commencing at its intersection with Rothesay Road and extending in an easterly direction following the northern kerbline for 21 metres.</i>

bbb) GIVE WAY AND NO STOPPING AT ALL TIMES - CHELMSFORD STREET – CLAIRE STREET – NGAIO – (87-07)

Add to Schedule G (Give Way and Stop Controls) of the Traffic Restrictions Schedule.

<i>Column One</i>	<i>Column Two</i>	<i>Column Three</i>
<i>Claire Street</i>	<i>Give Way.</i>	<i>Eastbound, at its intersection with Chelmsford Street.</i>

Add to Schedule D (No Stopping Restrictions) of the Traffic Restrictions Schedule.

<i>Column One</i>	<i>Column Two</i>	<i>Column Three</i>
<i>Claire Street</i>	<i>No Stopping At All Times.</i>	<i>North side, commencing at its intersection with Chelmsford Street and extending in a westerly direction</i>

following the northern kerbline for 14 metres.

**ccc) GIVE WAY AND NO STOPPING AT ALL TIMES -
CHELMSFORD STREET – KARAMU CRESCENT – NGAIO
– (88-07)**

Add to Schedule G (Give Way and Stop Controls) of the Traffic Restrictions Schedule.

<i>Column One</i>	<i>Column Two</i>	<i>Column Three</i>
<i>Karamu Crescent</i>	<i>Give Way.</i>	<i>Southbound, at its intersection with Chelmsford Street.</i>

Add to Schedule D (No Stopping Restrictions) of the Traffic Restrictions Schedule.

<i>Column One</i>	<i>Column Two</i>	<i>Column Three</i>
<i>Karamu Crescent</i>	<i>No Stopping At All Times.</i>	<i>East side, commencing at its intersection with Chelmsford Street and extending in a northerly direction following the eastern kerbline for 14 metres.</i>

**ddd) GIVE WAY AND NO STOPPING AT ALL TIMES -
MOTUEKA STREET – CHELMSFORD STREET – NGAIO –
(89-07)**

Add to Schedule G (Give Way and Stop Controls) of the Traffic Restrictions Schedule.

<i>Column One</i>	<i>Column Two</i>	<i>Column Three</i>
<i>Motueka Street</i>	<i>Give Way.</i>	<i>Eastbound, at its intersection with Chelmsford Street.</i>

Add to Schedule D (No Stopping Restrictions) of the Traffic Restrictions Schedule.

<i>Column One</i>	<i>Column Two</i>	<i>Column Three</i>
<i>Motueka Street</i>	<i>No Stopping At All</i>	<i>North side,</i>

	<i>Times.</i>	<i>commencing at its intersection with Chelmsford Street and extending in a westerly direction following the northern kerbline for 12.5 metres.</i>
<i>Motueka Street</i>	<i>No Stopping At All Times.</i>	<i>South side, commencing at its intersection with Chelmsford Street and extending in a westerly direction following the southern kerbline for 14.5 metres.</i>
<i>Chelmsford Street</i>	<i>No Stopping At All Times.</i>	<i>West side, commencing at its intersection with Motueka Street and extending in a southerly direction following the western kerbline for 5 metres.</i>

eee) GIVE WAY, NO STOPPING AT ALL TIMES AND PEDESTRIAN CROSSING - BOX HILL – CLARK STREET– KHANDALLAH – (90-07)

Add to Schedule G (Give Way and Stop Controls) of the Traffic Restrictions Schedule.

<i>Column One</i> <i>Clark Street</i>	<i>Column Two</i> <i>Give Way.</i>	<i>Column Three</i> <i>Eastbound, at its intersection with Box Hill.</i>
--	---------------------------------------	---

Add to Schedule D (No Stopping Restrictions) of the Traffic Restrictions Schedule.

<i>Column One</i> <i>Clark Street</i>	<i>Column Two</i> <i>No Stopping At All Times.</i>	<i>Column Three</i> <i>North side, commencing at its</i>
--	---	---

Box Hill	<i>No Stopping At All Times.</i>	<i>intersection with Box Hill and extending in a westerly direction following the northern kerbline for 16 metres. West side, commencing at its intersection with Clark Street and extending in a southerly direction following the eastern kerbline for 26 metres.</i>
Box Hill	<i>No Stopping At All Times.</i>	<i>West side, commencing at its intersection with Clark Street and extending in a northerly direction following the eastern kerbline for 6 metres.</i>
Box Hill	<i>No Stopping At All Times.</i>	<i>East side, commencing at its intersection with Clark Street and extending in a southerly direction following the eastern kerbline for 36.5 metres.</i>

Add to Schedule H (Pedestrian Crossing) of the Traffic

Restrictions Schedule.

<i>Column One</i>	<i>Column Two</i>	<i>Column Three</i>
Box Hill	<i>Pedestrian Crossing.</i>	<i>10 metres south of its intersection with Clark Street.</i>

fff) NO STOPPING AT ALL TIMES AND BUS STOP - CLARK STREET- KHANDALLAH – (91-07)

Add to Schedule B (Bus Stops) of the Traffic Restrictions Schedule.

<i>Column One</i>	<i>Column Two</i>	<i>Column Three</i>
<i>Clark Street</i>	<i>Bus Stop At All Times.</i>	<i>North side, commencing 27 metres west of its intersection with Simla Crescent and extending in a westerly direction following the northern kerbline for 14 metres.</i>
<i>Clark Street</i>	<i>Bus Stop At All Times.</i>	<i>South side, commencing at its intersection with Simla Crescent and extending in a southerly direction following the southern kerbline for 12 metres.</i>

Add to Schedule D (No Stopping Restrictions) of the Traffic Restrictions Schedule.

<i>Column One</i>	<i>Column Two</i>	<i>Column Three</i>
<i>Clark Street</i>	<i>No Stopping At All Times.</i>	<i>North side, commencing at its intersection with Simla Crescent and extending in an easterly direction following the northern kerbline for 11 metres.</i>
<i>Clark Street</i>	<i>No Stopping At All Times.</i>	<i>South side, commencing 26 metres from its intersection with Simla Crescent and extending in an easterly direction following the southern kerbline for 9 metres.</i>

ggg) GIVE WAY - KHANDALLAH ROAD – SIMLA CRESCENT – KHANDALLAH – (92-07)

Add to Schedule G (Give Way and Stop Controls) of the Traffic Restrictions Schedule.

<i>Column One</i>	<i>Column Two</i>	<i>Column Three</i>
<i>Simla Crescent</i>	<i>Give Way.</i>	<i>Southbound, at its intersection with Khandallah Road.</i>

hhh) GIVE WAY – CHARTWELL DRIVE – CHURCHILL DRIVE - CHARTWELL – (93-07)

Add to Schedule G (Give Way and Stop controls) of the Traffic Resolutions Schedule.

<i>Column One</i>	<i>Column Two</i>	<i>Column Three</i>
<i>Chartwell Drive</i>	<i>Give Way.</i>	<i>Northbound, at its intersection with Churchill Drive.</i>

iii) METERED PARKING – VIVIAN STREET – TE ARO – (23-07)

Delete from Schedule B (Restricted Parking) of the Traffic Restrictions Schedule.

<i>Column One</i>	<i>Column Two</i>	<i>Column Three</i>
<i>Vivian Street</i>	<i>P10, Monday - Saturday, 8.00am – 6.00pm.</i>	<i>North side, commencing 11.5 metres east of its intersection with Taranaki Street and extending in an easterly direction following the northern kerbline for 16.5 metres.</i>

Add to Schedule A (Time Limited Parking) of the Traffic Restrictions Schedule.

<i>Column One</i>	<i>Column Two</i>	<i>Column Three</i>
<i>Vivian Street</i>	<i>Metered Parking P120 Maximum,</i>	<i>North side, commencing 11.5</i>

Monday - metres east of its
Thursday, 8.00am intersection with
-6.00pm, Friday, Taranaki Street and
8.00am -8.00pm, extending in an
Saturday, 8.00am easterly direction
- 6.00pm. following the
northern kerbline for
16.5 metres (3
spaces).

jjj) METERED PARKING – JESSIE STREET – TE ARO – (24-07)

Delete from Schedule D (No Stopping Restrictions) of the Traffic Restrictions Schedule.

Column One	Column Two	Column Three
Jessie Street	No Stopping At All Times.	North side, commencing 30 metres west of its intersection with Tory Street and extending in a westerly direction following the northern kerbline for 23 metres.

Add to Schedule A (Time Limited Parking) of the Traffic Restrictions Schedule.

Column One	Column Two	Column Three
Jessie Street	Metered Parking P120 Maximum, Monday - Thursday, 8.00am - 6.00pm, Friday, 8.00am - 8.00pm, Saturday, 8.00am - 6.00pm.	North side, commencing 30 metres west of its intersection with Tory Street and extending in a westerly direction following the northern kerbline for 23 metres (4 spaces).

kkk) METERED PARKING – HOLLAND STREET – TE ARO – (25-07)

Delete from Schedule B (Restricted Parking) of the Traffic Restrictions Schedule.

Column One	Column Two	Column Three
-------------------	-------------------	---------------------

Holland Street	<i>P5, Monday - Saturday, 8:00am - 6:00pm.</i>	<i>North side, commencing 6 metres west of its intersection with Tory Street and extending in a westerly direction following the northern kerbline for 25 metres.</i>
Holland Street	<i>P5, Monday - Saturday, 8:00am - 6:00pm.</i>	<i>North side, commencing 90 metres west of its intersection with Tory Street and extending in a westerly direction following the northern kerbline for 11 metres.</i>

Add to Schedule A (Time Limited Parking) of the Traffic Restrictions Schedule.

Column One	Column Two	Column Three
Holland Street	<i>Metered Parking P120 Maximum, Monday - Thursday, 8.00am - 6.00pm, Friday, 8.00am - 8.00pm, Saturday, 8.00am - 6.00pm.</i>	<i>North side, commencing 6 metres west of its intersection with Tory Street and extending in a westerly direction following the northern kerbline for 25 metres (4 spaces).</i>
Holland Street	<i>Metered Parking P120 Maximum, Monday - Thursday, 8.00am - 6.00pm, Friday, 8.00am - 8.00pm, Saturday, 8.00am - 6.00pm.</i>	<i>North side, commencing 90 metres west of its intersection with Tory Street and extending in a westerly direction following the northern kerbline for 11 metres (2 spaces).</i>

III) METERED PARKING – BRANDON STREET – LAMBTON – (26-07)

Delete from Schedule D (No Stopping Restrictions) of the Traffic Restrictions Schedule.

Column One	Column Two	Column Three
-------------------	-------------------	---------------------

Brandon Street	No Stopping At All Times.	<i>South side, commencing 23 metres west of its intersection with Featherston Street and extending in a westerly direction following the southern kerbline for 5 metres.</i>
-----------------------	----------------------------------	--

Add to Schedule A (Time Limited Parking) of the Traffic Restrictions Schedule.

Column One	Column Two	Column Three
Brandon Street	Metered Parking P120 Maximum, Monday - Thursday, 8.00am -6.00pm, Friday, 8.00am -8.00pm, Saturday, 8.00am - 6.00pm.	<i>South side, commencing 23 metres west of its intersection with Featherston Street and extending in a westerly direction following the southern kerbline for 5 metres (1 space).</i>

mmm) METERED PARKING – VICTORIA STREET – LAMBTON – (27-07)

Delete from Schedule D (No Stopping Restrictions) of the Traffic Restrictions Schedule.

Column One	Column Two	Column Three
Victoria Street	No Stopping At All Times.	<i>East side, commencing 81 metres south of its intersection with Vivian Street and extending in a southerly direction following the eastern kerbline for 6 metres.</i>

Add to Schedule A (Time Limited Parking) of the Traffic Restrictions Schedule.

Column One	Column Two	Column Three
Victoria Street	Metered Parking P120 Maximum,	East side, commencing 81

Monday - Thursday, 8.00am - 6.00pm,
 Friday, 8.00am - 8.00pm, Saturday,
 8.00am - 6.00pm. metres south of its
 intersection with
 Victoria Street and
 extending in a
 southerly direction
 following the eastern
 kerbline for 6 metres
 (1 space).

nnn) METERED PARKING – TENNYSON STREET – TE ARO – (28-07)

Delete from Schedule D (Time Limited Parking) of the Traffic Restrictions Schedule.

Column One Tennyson Street	Column Two Metered Parking P120 Maximum, Monday - Thursday, 8.00am - 6.00pm, Friday, 8.00am - 8.00pm, Saturday, 8.00am - 4.00pm.	Column Three South side, commencing 157 metres west of its intersection with Cambridge Terrace and extending in a westerly direction following the southern kerbline for 44 metres.
---	--	--

Add to Schedule A (Time Limited Parking) of the Traffic Restrictions Schedule.

Column One Tennyson Street	Column Two Metered Parking P120 Maximum, Monday - Thursday, 8.00am - 6.00pm, Friday, 8.00am - 8.00pm, Saturday, 8.00am - 6.00pm.	Column Three South side, commencing 147 metres west of its intersection with Cambridge Terrace and extending in a westerly direction following the southern kerbline for 57 metres (13 spaces).
---	---	--

ooo) MOBILITY PARKING – ALLEN STREET – TE ARO – (29-07)

Delete from Schedule A (Time Limited Parking) of the Traffic Restrictions Schedule.

Column One	Column Two	Column Three
Allen Street	P120, Monday - Thursday, 8.00am - 6.00pm, Friday, 8.00am - 8.00pm, Saturday, 8.00am - 4.00pm.	West side, commencing 115.5 metres south of its intersection with Wakefield Street and extending in a southerly direction following the eastern kerbline for 5.5 metres.

Add to Schedule B (Restricted Parking) of the Traffic Restrictions Schedule.

Column One	Column Two	Column Three
Allen Street	Vehicles Displaying an Operational Mobility Permit Only, P120 Maximum, Monday - Thursday, 8.00am - 6.00pm, Friday, 8.00am - 8.00pm, Saturday, 8.00am - 6.00pm.	West side, commencing 115.5 metres south of its intersection with Wakefield Street and extending in a southerly direction following the eastern kerbline for 7.5 metres (1 space).

ppp) MOBILITY PARKING – BLAIR STREET – TE ARO – (30-07)

Delete from Schedule A (Time Limited Parking) of the Traffic Restrictions Schedule.

Column One	Column Two	Column Three
Blair Street	P120, Monday - Thursday, 8.00am - 6.00pm, Friday, 8.00am - 8.00pm, Saturday, 8.00am - 4.00pm.	West side, commencing 101 metres south of its intersection with Wakefield Street and extending in a southerly direction following the eastern

kerbline for 5.5 metres.

Add to Schedule B (Restricted Parking) of the Traffic Restrictions Schedule.

Column One	Column Two	Column Three
Blair Street	Vehicles Displaying an Operational Mobility Permit Only, Monday - Thursday, 8.00am - 6.00pm, Friday, 8.00am - 8.00pm, Saturday, 8.00am - 6.00pm.	West side, commencing 101 metres south of its intersection with Wakefield Street and extending in a southerly direction following the eastern kerbline for 7.5 metres (2 spaces).

qqq) MOBILITY PARKING – GREY STREET – LAMBTON – (31-07)

Delete from Schedule A (Time Limited Parking) of the Traffic Restrictions Schedule.

Column One	Column Two	Column Three
Grey Street	P120, Monday - Thursday, 8.00am - 6.00pm, Friday 8.00am - 8.00pm, Saturday, 8.00am - 4.00pm.	North side, commencing 23 metres west of its intersection with Featherston Street and extending in a westerly direction following the northern kerbline for 3 metres.

Add to Schedule B (Restricted Parking) of the Traffic Restrictions Schedule.

Column One	Column Two	Column Three
Grey Street	Vehicles Displaying an Operational Mobility Permit Only, P120 Maximum, Monday - Thursday, 8.00am - 6.00pm, Friday, 8.00am - 8.00pm, Saturday, 8.00am - 6.00pm.	North side, commencing 23 metres west of its intersection with Featherston Street and extending in a westerly direction following the northern kerbline

for 3 metres (1 space).

rrr) MOBILITY PARKING – ORIENTAL PARADE – MT VICTORIA – (32-07)

Delete from Schedule A (Time Limited Parking) of the Traffic Restrictions Schedule.

Column One	Column Two	Column Three
Oriental Parade	P120, Monday - Thursday, 8.00am - 6.00pm, Friday, 8.00am - 8.00pm, Saturday 8.00am - 6.00pm.	North side, commencing 45 metres east of its intersection with Cable Street and extending in an easterly direction following the northern kerbline for 7.5 metres.

Add to Schedule B (Restricted Parking) of the Traffic Restrictions Schedule.

Column One	Column Two	Column Three
Oriental Parade	Vehicles Displaying an Operational Mobility Permit Only, P120 Maximum, Monday - Thursday, 8.00am - 6.00pm, Friday 8.00am - 8.00pm, Saturday, 8.00am - 6.00pm.	North side, commencing 36 metres east of its intersection with Cable Street and extending in an easterly direction following the northern kerbline for 7.5 metres (2 spaces).

sss) P15 LOADING ZONE – MAGINNITY STREET - LAMBTON – (33-07)

Delete from Schedule A (Time Limited Parking) of the Traffic Restrictions Schedule.

Column One	Column Two	Column Three
Maginnity Street	P10 Loading Zone, Monday - Saturday, 8.00am - 6.00pm, Goods and Authorised Vehicles	East side, commencing 9.5 metres north of its intersection with

Only.

Waring Taylor Street and extending in a northerly direction following the eastern kerbline for 16 metres.

Add to Schedule B (Restricted Parking) of the Traffic Restrictions Schedule.

<i>Column One</i>	<i>Column Two</i>	<i>Column Three</i>
<i>Maginnity Street</i>	<i>P15 Loading Zone, Monday - Saturday, 8.00am - 6.00pm, Goods and Authorised Vehicles Only.</i>	<i>East side, commencing 9.5 metres north of its intersection with Waring Taylor Street and extending in a northerly direction following the eastern kerbline for 16 metres.</i>

ttt) BUS STOP - DEKKA STREET AND GANGES ROAD – KHANDALLAH – (04-07)

Delete from Schedule B (Bus Stops) of the Traffic Restrictions Schedule.

<i>Column One</i>	<i>Column Two</i>	<i>Column Three</i>
<i>Ganges Road</i>	<i>Bus Stop At All Times.</i>	<i>East side, commencing 150 metres south of its intersection with Agra Crescent and extending in a southerly direction following the eastern kerbline for 10.5 metres.</i>
<i>Ganges Road</i>	<i>Bus Stop At All Times.</i>	<i>West side, commencing 11 metres west of its intersection with Dekka Street and extending in a southerly direction following the western kerbline for 12.5</i>

metres.

Add to Schedule B (Bus Stops) of the Traffic Restrictions Schedule.

<i>Column One</i>	<i>Column Two</i>	<i>Column Three</i>
<i>Dekka Street</i>	<i>Bus Stop At All Times.</i>	<i>South side, commencing 14 metres west of its intersection with Ganges Road and extending in a westerly direction following the southern kerbline for 24 metres.</i>
<i>Dekka Street</i>	<i>Bus Stop At All Times.</i>	<i>North side, commencing 101 metres east of its intersection with Nicholson Road and extending in an easterly direction following the northern kerbline for 20 metres.</i>

uuu) NO STOPPING AT ALL TIMES – BEAZLEY AVENUE – PAPANANGI – (10-07)

Add to Schedule D (No Stopping Restrictions) of the Traffic Restrictions Schedule.

<i>Column One</i>	<i>Column Two</i>	<i>Column Three</i>
<i>Beazley Avenue</i>	<i>No Stopping At All Times.</i>	<i>West side, commencing 50 metres north of its intersection with Helston Road and extending in a northerly direction following the western kerbline for 28 metres.</i>
<i>Beazley Avenue</i>	<i>No Stopping At All Times.</i>	<i>East side, commencing 34 metres north of its intersection with Helston Road and extending in a northerly direction following the eastern</i>

kerbline for 30 metres.

vvv) **NO STOPPING AT ALL TIMES – GHUZNEE STREET – TE ARO**

Delete from Schedule D (No Stopping restrictions), of the Traffic Restrictions schedule.

All current No Stopping restrictions in Ghuznee Street from its intersection with Willis Street and extending in an easterly direction through to its intersection with Cambridge Terrace.

Add to Schedule D (No Stopping restrictions), of the Traffic Restrictions schedule.

Column One	Column Two	Column Three
Ghuznee St-Te Aro	No Stopping At All times	North side, commencing at its intersection with The Terrace and extending in an easterly direction following the northern kerb line for 114 metres.
Ghuznee St-Te Aro	No Stopping At All times	North side, commencing 129 metres east of its intersection with The Terrace and extending in an easterly direction following the northern kerb line for 65 metres.
Ghuznee St-Te Aro	No Stopping At All times	North side, commencing 6 metres east of its intersection with Willis Street and extending in an easterly direction following the northern kerb line for 24 metres.
Ghuznee St-Te Aro	No Stopping At All times	North side, commencing 75 metres east of its

		<i>intersection with Willis Street and extending in an easterly direction following the northern kerb line for 6 metres.</i>
<i>Ghuznee St-Te Aro</i>	<i>No Stopping At All times</i>	<i>North side, commencing at its intersection with Victoria Street and extending in an easterly direction following the northern kerb line for 33 metres.</i>
<i>Ghuznee St-Te Aro</i>	<i>No Stopping At All times</i>	<i>North side, commencing 44 metres east of its intersection with Victoria Street and extending in an easterly direction following the northern kerb line for 13 metres.</i>
<i>Ghuznee St-Te Aro</i>	<i>No Stopping At All times</i>	<i>North side, commencing 73 metres east of its intersection with Victoria Street and extending in an easterly direction following the northern kerb line for 7 metres.</i>
<i>Ghuznee St-Te Aro</i>	<i>No Stopping At All times</i>	<i>North side, commencing 100 metres east of its intersection with Victoria Street and extending in an easterly direction following the northern kerb line for 20 metres.</i>
<i>Ghuznee St-Te Aro</i>	<i>No Stopping At All times</i>	<i>North side, commencing 132</i>

		<i>metres east of its intersection with Victoria Street and extending in an easterly direction following the northern kerb line for 6 metres.</i>
<i>Ghuznee St-Te Aro</i>	<i>No Stopping At All times</i>	<i>North side, commencing at its intersection with Cuba Mall and extending in an easterly direction following the northern kerb line for 10 metres.</i>
<i>Ghuznee St-Te Aro</i>	<i>No Stopping At All times</i>	<i>North side, commencing 30 metres east of its intersection with Cuba Mall and extending in an easterly direction following the northern kerb line for 10 metres.</i>
<i>Ghuznee St-Te Aro</i>	<i>No Stopping At All times</i>	<i>North side, commencing 68 metres east of its intersection with Cuba Mall and extending in an easterly direction following the northern kerb line for 6 metres.</i>
<i>Ghuznee St-Te Aro</i>	<i>No Stopping At All times</i>	<i>North side, commencing at its intersection with Leeds Street and extending in an easterly direction following the northern kerb line for 18 metres.</i>
<i>Ghuznee St-Te Aro</i>	<i>No Stopping At All times</i>	<i>North side, commencing 42</i>

		<i>metres east of its intersection with Leeds Street and extending in an easterly direction following the northern kerb line for 9 metres.</i>
<i>Ghuznee St-Te Aro</i>	<i>No Stopping At All times</i>	<i>North side, commencing 80 metres east of its intersection with Leeds Street and extending in an easterly direction following the northern kerb line for 26 metres.</i>
<i>Ghuznee St-Te Aro</i>	<i>No Stopping At All times</i>	<i>South side, commencing at its intersection with The Terrace and extending in an easterly direction following the southern kerb line for 67 metres.</i>
<i>Ghuznee St-Te Aro</i>	<i>No Stopping At All times</i>	<i>South side, commencing 6 metres west of its intersection with Willis Street and extending in an westerly direction following the southern kerb line for 104 metres.</i>
<i>Ghuznee St-Te Aro</i>	<i>No Stopping At All times</i>	<i>South side, commencing at its intersection with Cuba Street and extending in an westerly direction following the southern kerb line for 10 metres.</i>
<i>Ghuznee St-Te Aro</i>	<i>No Stopping At All times</i>	<i>South side, commencing 72</i>

		<i>metres west of its intersection with Marion Street and extending in an westerly direction following the southern kerb line for 10 metres.</i>
<i>Ghuznee St-Te Aro</i>	<i>No Stopping At All times</i>	<i>South side, commencing at its intersection with Taranaki Street and extending in an easterly direction following the southern kerb line for 22 metres.</i>

www) METERED PARKING – GHUZNEE STREET – TE ARO

Delete from Schedule A (Time Limited Parking), of the Traffic Restrictions schedule.

All current Time Limited Parking in Ghuznee Street from its intersection with Willis Street and extending in an easterly direction through to its intersection with Cambridge Terrace

Add to Schedule A (Time Limited Parking), of the Traffic Restrictions schedule.

<i>Column One</i>	<i>Column Two</i>	<i>Column Three</i>
<i>Ghuznee St-Te Aro</i>	<i>Metered Parking P120 Maximum, Monday-Thursday, 8.00am – 6.00pm, Friday 8.00am – 8.00pm, Saturday 8.00am – 6.00pm</i>	<i>North side, commencing 30 metres east of its intersection with Willis Street and extending in an easterly direction following the northern kerb line for 44 metres.(7 car parks)</i>
<i>Ghuznee St-Te Aro</i>	<i>Metered Parking P120 Maximum, Monday-Thursday, 8.00am – 6.00pm, Friday 8.00am – 8.00pm, Saturday 8.00am – 6.00pm</i>	<i>North side, commencing 57 metres east of its intersection with Victoria Street and extending in an</i>

<i>Ghuznee St- Te Aro</i>	<i>Metered Parking P120 Maximum, Monday- Thursday, 8.00am – 6.00pm, Friday 8.00am – 8.00pm, Saturday 8.00am – 6.00pm</i>	<i>easterly direction following the northern kerb line for 16 metres.(3 car parks) North side, commencing 80 metres east of its intersection with Victoria Street and extending in an easterly direction following the northern kerb line for 12 metres.(2 car parks)</i>
<i>Ghuznee St- Te Aro</i>	<i>Metered Parking P120 Maximum, Monday- Thursday, 8.00am – 6.00pm, Friday 8.00am – 8.00pm, Saturday 8.00am – 6.00pm</i>	<i>North side, commencing 120 metres east of its intersection with Victoria Street and extending in an easterly direction following the northern kerb line for 12 metres.(2 car parks)</i>
<i>Ghuznee St- Te Aro</i>	<i>Metered Parking P120 Maximum, Monday- Thursday, 8.00am – 6.00pm, Friday 8.00am – 8.00pm, Saturday 8.00am – 6.00pm</i>	<i>North side, commencing 120 metres east of its intersection with Victoria Street and extending in an easterly direction following the northern kerb line for 12 metres.(2 car parks)</i>
<i>Ghuznee St- Te Aro</i>	<i>Metered Parking P120 Maximum, Monday- Thursday, 8.00am – 6.00pm, Friday 8.00am – 8.00pm, Saturday 8.00am – 6.00pm</i>	<i>North side, commencing 18 metres east of its intersection with Cuba Mall and extending in an easterly direction following the northern kerb line for 6 metres.(1 car</i>

<i>Ghuznee St- Te Aro</i>	<i>Metered Parking P120 Maximum, Monday- Thursday, 8.00am – 6.00pm, Friday 8.00am – 8.00pm, Saturday 8.00am – 6.00pm</i>	<i>parks) North side, commencing 54 metres east of its intersection with Cuba Mall and extending in an easterly direction following the northern kerb line for 12 metres.(2 car parks)</i>
<i>Ghuznee St- Te Aro</i>	<i>Metered Parking P120 Maximum, Monday- Thursday, 8.00am – 6.00pm, Friday 8.00am – 8.00pm, Saturday 8.00am – 6.00pm</i>	<i>North side, commencing 18 metres east of its intersection with Leeds Street and extending in an easterly direction following the northern kerb line for 24 metres.(4 car parks)</i>
<i>Ghuznee St- Te Aro</i>	<i>Metered Parking P120 Maximum, Monday- Thursday, 8.00am – 6.00pm, Friday 8.00am – 8.00pm, Saturday 8.00am – 6.00pm</i>	<i>North side, commencing 51 metres east of its intersection with Leeds Street and extending in an easterly direction following the northern kerb line for 30metres.(5 car parks)</i>
<i>Ghuznee St- Te Aro</i>	<i>Metered Parking P120 Maximum, Monday- Thursday, 8.00am – 6.00pm, Friday 8.00am – 8.00pm, Saturday 8.00am – 6.00pm</i>	<i>South side, commencing 10 metres west of its intersection with Victoria Street and extending in an westerly direction following the southern kerb line for 24 metres.(4 car parks)</i>
<i>Ghuznee St- Te Aro</i>	<i>Metered Parking P120 Maximum, Monday- Thursday, 8.00am –</i>	<i>South side, commencing 65 metres west of its</i>

	6.00pm, Friday 8.00am – 8.00pm, Saturday 8.00am – 6.00pm	intersection with Victoria Street and extending in an westerly direction following the southern kerb line for 24 metres.(4 car parks)
<i>Ghuznee St-Te Aro</i>	<i>Metered Parking P120 Maximum, Monday-Thursday, 8.00am – 6.00pm, Friday 8.00am – 8.00pm, Saturday 8.00am – 6.00pm</i>	South side, commencing 12 metres west of its intersection with Victoria Street and extending in an westerly direction following the southern kerb line for 42 metres.(7 car parks)
<i>Ghuznee St-Te Aro</i>	<i>Metered Parking P120 Maximum, Monday-Thursday, 8.00am – 6.00pm, Friday 8.00am – 8.00pm, Saturday 8.00am – 6.00pm</i>	South side, commencing 30 metres west of its intersection with Marion Street and extending in an westerly direction following the southern kerb line for 36metres.(6 car parks)
<i>Ghuznee St-Te Aro</i>	<i>Metered Parking P120 Maximum, Monday-Thursday, 8.00am – 6.00pm, Friday 8.00am – 8.00pm, Saturday 8.00am – 6.00pm</i>	South side, commencing 20 metres west of its intersection with Furness Lane and extending in an westerly direction following the southern kerb line for 36metres.(6 car parks)

xxx) BUS STOP – GHUZNEE STREET – TE ARO

Add to Schedule B (Restricted Parking), of the Traffic Restrictions schedule.

Column One

Column Two

Column Three

<i>Ghuznee St- Te Aro</i>	<i>Bus Stop – At All Times</i>	<i>North side, commencing 114 metres at its intersection with The Terrace and extending in an easterly direction following the northern kerb line for 15 metres.</i>
<i>Ghuznee St- Te Aro</i>	<i>Bus Stop –At All Times</i>	<i>North side, commencing 38 metres east of its intersection with Cuba Mall and extending in a easterly direction following the northern kerb line for 15 metres.</i>
<i>Ghuznee St- Te Aro</i>	<i>Bus Stop –At All Times</i>	<i>South side, commencing 60 metres west of its intersection with Victoria Street and extending in an westerly direction following the southern kerb line for 10 metres.</i>
<i>Ghuznee St- Te Aro</i>	<i>No Stopping At All times</i>	<i>South side, commencing at its intersection with Marion Street and extending in a westerly direction following the southern kerb line for 22 metres.</i>

yyy)LOADING ZONES AT ALL TIMES – GHUZNEE STREET – TE ARO –

Delete from Schedule B (Restricted Parking),of the Traffic Restrictions schedule

<i>Column One</i>	<i>Column Two</i>	<i>Column Three</i>
<i>Ghuznee St-</i>	<i>Loading Zone At Al</i>	<i>South side,</i>

Te Aro	Times	<i>commencing 18 metres west of its intersection with Furness Lane and extending in a westerly direction following the southern kerb line for 11 metres.</i>
---------------	--------------	--

Add to Schedule B (Restricted Parking), of the Traffic Restrictions schedule.

Column One	Column Two	Column Three
Ghuznee St- Te Aro	Loading Zone At All Times	<i>North side, commencing 33 metres east of its intersection with Victoria Street and extending in an easterly direction following the southern kerb line for 11 metres.</i>
Ghuznee St- Te Aro	Loading Zone At All Times	<i>North side, commencing 92 metres east of its intersection with Victoria Street and extending in an easterly direction following the southern kerb line for 8 metres.</i>
Ghuznee St- Te Aro	Loading Zone At All Times	<i>North side, commencing 10 metres east of its intersection with Cuba Mall and extending in an easterly direction following the southern kerb line for 8 metres.</i>
Ghuznee St- Te Aro	Loading Zone At All Times	<i>South side, commencing 22 metres west of its intersection with</i>

Ghuznee St- Te Aro	Loading Zone At All Times	<i>Marion Street and extending in an westerly direction following the southern kerb line for 8 metres. South side, commencing 6 metres west of its intersection with Furness Lane and extending in an westerly direction following the southern kerb line for 12 metres.</i>
-------------------------------	--------------------------------------	--

zzz) MOBILITY PARKING – GHUZNEE STREET – TE ARO

Add to Schedule B (Restricted Parking), of the Traffic Restrictions schedule

Column One	Column Two	Column Three
Ghuznee St- Te Aro	Mobility Parking- Metered Parking P120 Maximum, Monday- Thursday, 8.00am – 6.00pm, Friday 8.00am – 8.00pm, Saturday 8.00am – 6.00pm	<i>North side, commencing 24 metres east of its intersection with Cuba Mall and extending in an easterly direction following the Northern kerb line for 6 metres.</i>

aaaa) CLEARWAY – GHUZNEE STREET – TE ARO

Delete from Schedule D (No Stopping restrictions), of the Traffic Restrictions schedule.

All current Clearway restrictions in Ghuznee Street from its intersection with Willis Street and extending in an easterly direction through to its intersection with Cambridge Terrace.

bbbb) NO STOPPING AT ALL TIMES – VIVIAN STREET – TE ARO

Delete from Schedule D (No Stopping restrictions), of the Traffic Restrictions schedule

All current No Stopping restrictions in Vivian Street from its intersection with Willis Street and extending in an easterly direction through to its intersection with Cambridge Terrace.

Add to Schedule D (No Stopping restrictions), of the Traffic Restrictions schedule.

<i>Column One</i>	<i>Column Two</i>	<i>Column Three</i>
<i>Vivian St- Te Aro</i>	<i>No Stopping At All Times</i>	<i>North side, commencing 6 metres east of its intersection with Willis Street and extending in an easterly direction following the northern kerb line for 57 metres.</i>
<i>Vivian St- Te Aro</i>	<i>No Stopping At All Times</i>	<i>North side, commencing 95 metres east of its intersection with Willis Street and extending in an easterly direction following the northern kerb line for 68 metres.</i>
<i>Vivian St- Te Aro</i>	<i>No Stopping At All Times</i>	<i>North side, commencing at its intersection with Bute Street and extending in an easterly direction following the northern kerb line for 68 metres.</i>
<i>Vivian St- Te Aro</i>	<i>No Stopping At All times</i>	<i>North side, commencing at its intersection with Cuba Street and extending in an easterly direction following the northern kerb line for 14 metres.</i>
<i>Vivian St- Te</i>	<i>No Stopping At All</i>	<i>North side,</i>

<i>Aro</i>	<i>Times</i>	<i>commencing 20 metres east of its intersection with Cuba Street and extending in an easterly direction following the northern kerb line for 6 metres.</i>
<i>Vivian St- Te Aro</i>	<i>No Stopping At All Times</i>	<i>North side, commencing 42 metres east of its intersection with Cuba Street and extending in an easterly direction following the northern kerb line for 4 metres.</i>
<i>Vivian St- Te Aro</i>	<i>No Stopping At All Times</i>	<i>North side, commencing 66 metres east of its intersection with Cuba Street and extending in an easterly direction following the northern kerb line for 10 metres.</i>
<i>Vivian St- Te Aro</i>	<i>No Stopping At All Times</i>	<i>North side, commencing at its intersection with Marion Street and extending in an easterly direction following the northern kerb line for 10 metres.</i>
<i>Vivian St- Te Aro</i>	<i>No Stopping At All Times</i>	<i>North side, commencing 58 metres east of its intersection with Marion Street and extending in an easterly direction following the northern kerb line for 30 metres.</i>

<i>Vivian St- Te Aro</i>	<i>No Stopping At All Times</i>	<i>North side, commencing at its intersection with Taranaki Street and extending in an easterly direction following the northern kerb line for 10 metres.</i>
<i>Vivian St- Te Aro</i>	<i>No Stopping At All Times</i>	<i>North side, commencing 22 metres east of its intersection with Taranaki Street and extending in an easterly direction following the northern kerb line for 12 metres.</i>
<i>Vivian St- Te Aro</i>	<i>No Stopping At All Times</i>	<i>North side, commencing 40 metres east of its intersection with Taranaki Street and extending in an easterly direction following the northern kerb line for 6 metres.</i>
<i>Vivian St- Te Aro</i>	<i>No Stopping At All Times</i>	<i>North side, commencing 70 metres east of its intersection with Taranaki Street and extending in an easterly direction following the northern kerb line for 53 metres.</i>
<i>Vivian St- Te Aro</i>	<i>No Stopping At All Times</i>	<i>North side, commencing at its intersection with Tory Street and extending in an easterly direction following the northern kerb line for 6 metres.</i>

<i>Vivian St- Te Aro</i>	<i>No Stopping At All Times</i>	<i>North side, commencing 22 metres east of its intersection with Tory Street and extending in an easterly direction following the northern kerb line for 6 metres.</i>
<i>Vivian St- Te Aro</i>	<i>No Stopping At All Times</i>	<i>North side, commencing 58 metres east of its intersection with Tory Street and extending in an easterly direction following the northern kerb line for 34 metres.</i>
<i>Vivian St- Te Aro</i>	<i>No Stopping At All Times</i>	<i>South side, commencing 6 metres east of its intersection with Willis Street and extending in an easterly direction following the southern kerb line for 57 metres.</i>
<i>Vivian St- Te Aro</i>	<i>No Stopping At All Times</i>	<i>South side, commencing 42 metres east of its intersection with Victoria Street and extending in an easterly direction following the southern kerb line for 6 metres.</i>
<i>Vivian St- Te Aro</i>	<i>No Stopping At All Times</i>	<i>South side, commencing at its intersection with Walter Street and extending in an easterly direction following the southern kerb line</i>

<i>Vivian St- Te Aro</i>	<i>No Stopping At All Times</i>	<i>for 6 metres. South side, commencing 54 metres east of its intersection with Walter Street and extending in an easterly direction following the southern kerb line for 10 metres.</i>
<i>Vivian St- Te Aro</i>	<i>No Stopping At All Times</i>	<i>South side, commencing 82 metres east of its intersection with Walter Street and extending in an easterly direction following the southern kerb line for 6 metres.</i>
<i>Vivian St- Te Aro</i>	<i>No Stopping At All Times</i>	<i>South side, commencing 100 metres east of its intersection with Walter Street and extending in an easterly direction following the southern kerb line for 12 metres.</i>
<i>Vivian St- Te Aro</i>	<i>No Stopping At All Times</i>	<i>South side, commencing at its intersection with Cuba Street and extending in an easterly direction following the southern kerb line for 40 metres.</i>
<i>Vivian St- Te Aro</i>	<i>No Stopping At All Times</i>	<i>South side, commencing at its intersection with Dunlop Terrace and extending in an easterly direction following the southern kerb line</i>

<i>Vivian St- Te Aro</i>	<i>No Stopping At All Times</i>	<i>for 70 metres. South side, commencing at its intersection with Knigges Avenue and extending in an easterly direction following the southern kerb line for 58 metres.</i>
<i>Vivian St- Te Aro</i>	<i>No Stopping At All Times</i>	<i>South side, commencing 6 metres east of its intersection with Taranaki Street and extending in an easterly direction following the southern kerb line for 198 metres.</i>
<i>Vivian St- Te Aro</i>	<i>No Stopping At All Times</i>	<i>South side, commencing 6 metres east of its intersection with Tory Street and extending in an easterly direction following the southern kerb line for 202 metres.</i>

cccc) METERED PARKING – VIVIAN STREET – TE ARO

Delete from Schedule A (Time Limited Parking), of the Traffic Restrictions schedule.

All current Time Limited Parking restrictions in Vivian Street from its intersection with Willis Street and extending in an easterly direction through to its intersection with Cambridge Terrace.

Add to Schedule A (Time Limited Parking), of the Traffic Restrictions schedule.

<i>Column One</i>	<i>Column Two</i>	<i>Column Three</i>
<i>Vivian St- Te Aro</i>	<i>Metered Parking P120 Maximum, Monday-Thursday, 8.00am – 6.00pm, Friday 8.00am –</i>	<i>South side, commencing 6 metres east of its intersection with</i>

	8.00pm, Saturday 8.00am – 6.00pm	Victoria Street and extending in an easterly direction following the southern kerb line for 36 metres.(6 car parks)
Vivian St- Te Aro	<i>Metered Parking P120 Maximum, Monday- Thursday, 8.00am – 6.00pm, Friday 8.00am – 8.00pm, Saturday 8.00am – 6.00pm</i>	South side, commencing 6 metres east of its intersection with Walter Street and extending in an easterly direction following the southern kerb line for 48 metres.(8 car parks)
Vivian St- Te Aro	<i>Metered Parking P120 Maximum, Monday- Thursday, 8.00am – 6.00pm, Friday 8.00am – 8.00pm, Saturday 8.00am – 6.00pm</i>	South side, commencing 64 metres east of its intersection with Walter Street and extending in an easterly direction following the southern kerb line for 18 metres.(3 car parks)
Vivian St- Te Aro	<i>Metered Parking P120 Maximum, Monday- Thursday, 8.00am – 6.00pm, Friday 8.00am – 8.00pm, Saturday 8.00am – 6.00pm</i>	South side, commencing 86 metres east of its intersection with Walter Street and extending in an easterly direction following the southern kerb line for 12 metres.(2 car parks)
Vivian St- Te Aro	<i>Metered Parking P120 Maximum, Monday- Thursday, 8.00am – 6.00pm, Friday 8.00am – 8.00pm, Saturday 8.00am – 6.00pm</i>	North side, commencing 53 metres east of its intersection with Cuba Street and extending in an easterly direction following the

		<i>northern kerb line for 24 metres.(4 car parks)</i>
<i>Vivian St- Te Aro</i>	<i>Metered Parking P120 Maximum, Monday-Thursday, 8.00am – 6.00pm, Friday 8.00am – 8.00pm, Saturday 8.00am – 6.00pm</i>	<i>North side, commencing 10 metres east of its intersection with Marion Street and extending in an easterly direction following the northern kerb line for 48 metres.(8 car parks)</i>
<i>Vivian St- Te Aro</i>	<i>Metered Parking P120 Maximum, Monday-Thursday, 8.00am – 6.00pm, Friday 8.00am – 8.00pm, Saturday 8.00am – 6.00pm</i>	<i>North side, commencing 10 metres east of its intersection with Taranaki Street and extending in an easterly direction following the northern kerb line for 12 metres.(2 car parks)</i>
<i>Vivian St- Te Aro</i>	<i>Metered Parking P120 Maximum, Monday-Thursday, 8.00am – 6.00pm, Friday 8.00am – 8.00pm, Saturday 8.00am – 6.00pm</i>	<i>North side, commencing 34 metres east of its intersection with Taranaki Street and extending in an easterly direction following the northern kerb line for 6 metres.(1 car parks)</i>
<i>Vivian St- Te Aro</i>	<i>Metered Parking P120 Maximum, Monday-Thursday, 8.00am – 6.00pm, Friday 8.00am – 8.00pm, Saturday 8.00am – 6.00pm</i>	<i>North side, commencing 45 metres east of its intersection with Taranaki Street and extending in an easterly direction following the northern kerb line for 66 metres.(11 car parks)</i>
<i>Vivian St- Te</i>	<i>Metered Parking P120</i>	<i>North side,</i>

Aro	<i>Maximum, Monday-Thursday, 8.00am – 6.00pm, Friday 8.00am – 8.00pm, Saturday 8.00am – 6.00pm</i>	<i>commencing 28 metres east of its intersection with Tory Street and extending in an easterly direction following the northern kerb line for 30 metres.(5 car parks)</i>
------------	--	---

dddd) RESTRICTED PARKING – Vivian Street – Te Aro –

Delete from Schedule B (Restricted Parking), of the Traffic Restrictions schedule

Column One <i>Vivian St- Te Aro</i>	Column Two <i>Taxi Stand</i>	Column Three <i>South side, commencing 6 metres west of its intersection with Dunlop Terrace and extending in an westerly direction following the southern kerb line for 24 metres. (4 Taxi parks)</i>
---	--	--

Add to Schedule B (Restricted Parking), of the Traffic Restrictions schedule.

Column One <i>Vivian St- Te Aro</i>	Column Two <i>Taxi Stand</i>	Column Three <i>North side, commencing 20 metres east of its intersection with Cuba Street and extending in an easterly direction following the southern kerb line for 6 metres. (1 Taxi park)</i>
Vivian St- Te Aro	Taxi Stand	<i>North side, commencing 32 metres east of its intersection with</i>

Cuba Street and extending in an easterly direction following the southern kerb line for 18 metres. (3 Taxi parks)

Reports from Committee - Part B

Committee decisions for Council to note

081/07P **RECEIPT OF INFORMATION FOR NOTING FROM COMMITTEES**
(1215/11/IM)

Moved Mayor Prendergast, seconded Councillor Cook the substantive motion that Council receive the information for noting from the Extraordinary Strategy and Policy Committee meeting of Thursday 26 April 2007, Strategy and Policy Committee meetings of Thursday 3 May 2007 and Thursday 10 May 2007.

(Councillor Goulden returned to the meeting at 6.15pm)

The substantive motion was put:

Voting for: Mayor Prendergast, Councillors Ahipene-Mercer, Armstrong, Cook, Foster, Gill, Goulden, McKinnon, Morrison, Pepperell, Ritchie, Ruben, Shaw, Wade-Brown and Wain.

Voting against: Nil.

Majority Vote: 15:0

The substantive motion was declared CARRIED.

RESOLVED:

THAT Council:

1. *Receive the information for noting from the Extraordinary Strategy and Policy Committee meeting of Thursday 26 April 2007, Strategy and Policy Committee meetings of Thursday 3 May 2007 and Thursday 10 May 2007.*

STRATEGY AND POLICY COMMITTEE
Extraordinary Meeting of Thursday 26 April 2007
(1215/11/IM)

(REPORT 7)

1. **ITEM 093/07P RATES INQUIRY SUBMISSION**
(1215/52/IM) (REPORT 1)

THAT the Strategy and Policy Committee:

1. *Receive the information.*
2. *Approve the draft submission attached as Appendix 1 to the officers report, as amended, to the Rates Inquiry being conducted by an Inquiry Panel on behalf of central government.*
3. *Agree to delegate to the Mayor and Chief Executive the authority to make any drafting changes before forwarding the submission.*

STRATEGY AND POLICY COMMITTEE
Meeting of Thursday 3 May 2007
(1215/11/IM)

(REPORT 8)

1. **ITEM 094/07P KARORI TOWN CENTRE REDEVELOPMENT PROJECT – OUTSTANDING ISSUES**
(1215/52/IM) (REPORT 2)

THAT the Strategy and Policy Committee:

1. *Receive the information.*
2. *Agree to the following next steps in the Karori Town Centre Redevelopment Project:*
 - a) *Landscaping of the site adjacent to the community centre, which is to be retained in Council ownership for future potential community facilities*
 - b) *Removal of the wooden hall and demolition of the associated buildings*
 - c) *Construction of the eastern pedestrian walkway to the Community Centre*
 - d) *Offer the Karori Community Centre a continued lease of the St John's building as a temporary community hall until the end of 2008*
 - e) *Discuss the future ownership, use and development of the St John site with affected and interested parties*

f) *Report back to the Strategy and Policy Committee regarding the most appropriate future use, ownership and zoning for the remainder of the St Johns site.*

3. *Note that the cost of the above works is \$360,000 and that this expenditure has been budgeted for in the Karori Town Centre project.*

4. *Note that in the most recent consultation over half of submitters requested that the St Johns site remain in public ownership and be retained for community use.*

5. *Note that the Karori Hall Replacement Committee is seeking alternative sources of funding to build a new community hall on the site adjacent to the new community centre.*

6. *That the land next to the Community Centre is made available to the Karori Community Centre and Karori Community Hall Replacement Committee* for the period of five years for the purpose of building a community hall.*

7. *That this arrangement will be reviewed by end of 2009 to determine whether significant progress has been made towards fundraising for a hall.*

*(*or a Trust to be established for the purposes of fundraising for and constructing a hall)*

2. ***ITEM 095/07P INFILL HOUSING REVIEW – PROPOSED DISTRICT PLAN CHANGE 56: MANAGING INFILL HOUSING DEVELOPMENT
(1215/52/IM) (REPORT 3)***

THAT the Strategy and Policy Committee:

1. *Receive the information.*

2. *Agree to notify Proposed Plan Change 56 (attached as Appendix one of the officer's report) in accordance with the First Schedule of the Resource Management Act 1991. Please note that an annotated version of the changes is attached as Appendix Four of this report.*

3. *Agree to adopt the Section 32 Report for Proposed Plan Change 56 (attached as Appendix two of the officer's report).*

4. *Note that the notification of Plan Change 56 will be coordinated with the release of the discussion paper on a targeted approach to infill housing to ensure a combined public consultation package on infill housing is presented to the public.*

5. *Delegate to the Portfolio Leader for Urban Development the authority to approve minor editorial changes to the proposed Plan Change, and the authority to sign off on the final plan change documentation prior to notification.*

3. **ITEM 096/07P INFILL HOUSING REVIEW/ A TARGETED APPROACH TO INFILL HOUSING IN WELLINGTON CITY**
(1215/52/IM) (REPORT 4)

THAT the Strategy and Policy Committee:

1. *Receive the information.*
2. *Agree to release the discussion paper on infill management (attached as Appendix one of the officers report) for public consultation.*
3. *Delegate to the Portfolio Leader for Urban Development the authority to approve minor editorial changes to the final version of the discussion paper.*
4. *Note that the release of the discussion paper will be coordinated with the notification of Proposed District Plan Change 56 to ensure a combined public consultation package on infill housing is presented to the public.*
5. *Note that the results of consultation and the proposed steps forward will be reported back to the Committee before the end of the year for further consideration.*

STRATEGY AND POLICY COMMITTEE

Meeting of Thursday 10 May

(1215/11/IM)

(REPORT 9)

1. **ITEM 104/07P REVIEW OF THE COUNCIL'S "CODE OF PRACTICE FOR LAND DEVELOPMENT"**
(1215/52/IM) (REPORT 6)

THAT the Strategy and Policy Committee:

1. *Receive the information.*
2. *Agree to the objectives of the Code of Practice (as presented in section 5.1 of the officer's report)*
3. *Agree that initially the Draft Code be used for internally instigated works and be a basis for assessment for land developments.*

4. *Agree that comments be invited on this Draft Code from practitioners.*
5. *Agree that more work be carried out to determine the most effective methodology for implementation.*

2. ***ITEM 105/07P REPORT OF THE COUNCIL CONTROLLED ORGANISATIONS SUBCOMMITTEE***
Meetings of Tuesday 27 February 2007 and Friday 13 April 2007.
(1215/52/IM) (REPORT 7)

THAT the Strategy and Policy Committee:

1. *Receive the information for noting from the Council Controlled Organisations Performance Subcommittee Meeting of 27 February 2007.*
 1. ***ITEM 007/07FM REVIEW OF THE PERFORMANCE OF ALL COUNCIL CONTROLLED ORGANISATIONS FOR THE QUARTER ENDED 30 SEPTEMBER 2006***
(1215/52/02IM)(REPORT 2)
 1. *Receive the information.*
 2. *Note that there were no issues to raise with the entities covered by this report.*
 3. *Note that there were no issues to raise with the Strategy and Policy Committee in regard to this report.*
 4. *Note the 2007/08 Letters of Expectation attached at appendix one of the officers report and provide any comment to officers ahead of the Statement of Intent process.*
 5. *Note the attached report from Mr Tiffin regarding the review of the relationship between Council Controlled Organisations and Council's Audit and Risk Management and Council Controlled Organisation Performance Subcommittees and provide any comment to officers ahead of a report to Strategy and Policy Committee on the issue.*
 2. ***ITEM 008/07FM REVIEW OF 2006/07 ANNUAL REPORTS AND FINANCIAL STATEMENTS OF COUNCIL ORGANISATIONS AND OTHER ENTITIES***
(1215/52/02IM)(REPORT 3)

1. *Receive the information.*
 2. *Confirm that there are no issues for the Chair of this Subcommittee to raise with the Council Organisations.*
 3. *Confirm that there are no issues to raise with the Strategy and Policy Committee.*
2. *Receive the information for noting from the Council Controlled Organisations Performance Subcommittee Meeting of Friday 13 April 2007.*

1. ***ITEM 017/07FM REVIEW OF THE PERFORMANCE OF ALL COUNCIL CONTROLLED ORGANISATIONS FOR THE QUARTER ENDED 31 DECEMBER 2006***
(1215/52/02IM)(REPORT 2)

1. *Receive the information.*
2. *Note that there were issues regarding the quality of the reports received from some of the Council Controlled Organisation's; officers will raise these issues with the individual Council Controlled Organisation's.*
3. *Note that there were no issues to raise with Strategy and Policy Committee in regard to this report.*
4. *Note that officers will continue to work with Carter Observatory Trust and Marine Education Centre to develop the content of their quarterly reports to the Subcommittee.*

2. ***ITEM 018/07FM DRAFT STATEMENTS OF INTENT FOR ALL COUNCIL CONTROLLED ORGANISATIONS FOR THE YEAR 2007/08***
(1215/52/02IM)(REPORT 3)

1. *Receive the information.*
2. *Note that officers work with all CCOs to continue to improve the quality of Statements of Intent over time, as recommended by the Roche Review of CCOs in 2006*
3. *Agree that officers request that CCOs make the following changes to their Statements of Intent for presentation to this Subcommittee at its meeting of 6 June 2007:*

CCO	Recommendations
Wellington Museums Trust	<ul style="list-style-type: none"> ➤ <i>produce missing 3 year forecasts</i> ➤ <i>provide information on how the Board will meet best practice standards and the Board development programme</i> ➤ <i>outline its audit and risk assurance processes, including internal audit</i>
Basin Reserve Trust	<ul style="list-style-type: none"> ➤ <i>provide an undertaking to work with the Council to achieve co-ordinated event management</i> ➤ <i>identify risks, and the associated mitigation strategies</i> ➤ <i>outline audit and risk assurance processes, including internal audit</i> ➤ <i>produce missing 3 year forecasts</i> ➤ <i>provide information on how the Board will meet best practice standards and the Board development programme</i>
Cable Car Company	<ul style="list-style-type: none"> ➤ <i>articulate future company strategies, including scenarios with/without overhead trolley network</i> ➤ <i>identify risks, and the associated mitigation strategies</i> ➤ <i>outline its audit and risk assurance processes, including internal audit</i> ➤ <i>produce missing 3 year forecasts</i> ➤ <i>provide information on how the Board will meet best practice standards and the Board development programme</i>
Positively Wellington Tourism	<ul style="list-style-type: none"> ➤ <i>include working with the Council Events team to develop a robust methodology to measure the economic impact of events</i> ➤ <i>include cost effectiveness and organisational health measures</i> ➤ <i>produce missing 3 year forecasts</i> ➤ <i>outline how its internal audit functions are provided for</i> ➤ <i>articulate its Board development programme</i>

CCO	Recommendations
St James Theatre Trust	<ul style="list-style-type: none"> ➤ <i>Raise the issue of an SOI or joint SOI for the St James Theatre Limited</i> ➤ <i>additional information about strategic direction – e.g. Trust taking greater role in productions, development of back lot</i> ➤ <i>include measures on organisational health and capacity</i> ➤ <i>produce missing 3 year forecasts</i> ➤ <i>provide information on how the Board will meet best practice standards and its Board development programme</i>
Wellington Waterfront Limited	<ul style="list-style-type: none"> ➤ <i>A number of the requirements for the SOI, as laid out in the Letter of Expectations are not attached to the SOI and will be received as part of the business plan</i> ➤ <i>In the Governance section, WWL assert that only the WWL Board can make decisions, including major capital projects and the approval of development contracts. The Companies Act 1993 says that a major transaction (greater than half the value of the company's assets) requires shareholder support for it to be approved</i> ➤ <i>produce missing 3 year forecasts</i> ➤ <i>include details of how it reviews and measures board performance, and of its board development programme</i> ➤ <i>a detailed assessment of all risks that might impact waterfront development and their proposed strategies for mitigation</i>
Wellington Zoo Trust	<ul style="list-style-type: none"> ➤ <i>ensure details of processes and controls for CAPEX development projects are included in the SOI.</i> ➤ <i>articulate how it reviews and measures board performance, and its board development programme.</i>

CCO	Recommendations
	<ul style="list-style-type: none"> ➤ <i>discuss all performance measures with the Trust, especially those which have decreased compared to 2006/07 and/or 2005/06.</i>
Capacity	<p><i>(These recommendations will need to be discussed with Hutt City Council):</i></p> <ul style="list-style-type: none"> ➤ <i>Consider requiring an explicit link to be made between the SOI and the Strategic Plan</i> ➤ <i>Explicitly recognise and outline how it will manage risks to the Council</i> ➤ <i>Agree to remove the specific performance measures and rely on the general requirement to comply with SLAs</i> ➤ <i>include measures on organisational health and capacity</i> ➤ <i>outline its audit and risk assurance processes, included internal audit</i> ➤ <i>produce missing 3 year forecasts</i> ➤ <i>provide information on how the Board will meet best practice standards and its Board development programme</i>

4. *Note that there are no issues to raise with Strategy and Policy Committee in regard to this report.*

3. **ITEM 019/07FM FORWARD PROGRAMME**
(1215/52/02IM)(REPORT 4)

1. *Receive the information.*
2. *Agree to the forward programme attached to the officer's report.*

082/07C **QUESTIONS**
(1215/11/IM)

NOTED:

There were no questions.

083/07C **RESOLUTION TO EXCLUDE THE PUBLIC**
(1215/11/IM)

Moved Mayor Prendergast, seconded Councillor Pepperell the motion that the public be excluded.

The motion was put:

Voting for: Mayor Prendergast, Councillors Ahipene-Mercer, Armstrong, Cook, Foster, Gill, Goulden, McKinnon, Morrison, Pepperell, Ritchie, Ruben, Shaw, Wade-Brown and Wain.

Voting against: Nil.

Majority Vote: 15:0

The motion was declared CARRIED.

RESOLVED:

THAT Council:

- 1. Pursuant to the provisions of the Local Government Official Information and Meetings Act 1987, resolve that the public be excluded from the following part of the proceedings of this meeting namely:*

Report 10: Appointments to Council Controlled Organisations

Grounds: Section 48(1)(a) That public conduct of this item would be likely to result in the disclosure of information for which good reasons for withholding would exist under Section 7.

Reasons: Section 7(2)(a) To protect the privacy of natural persons, including that of deceased natural persons.

Report 11: Strategy and Policy Committee – Meeting of Thursday 10 May 2007

Grounds : Section 48(1)(a) That public conduct of this item would be likely to result in the disclosure of information for which good reasons for withholding would exist under Section 7.

APPENDIX 1

Reserve Land Exchange areas

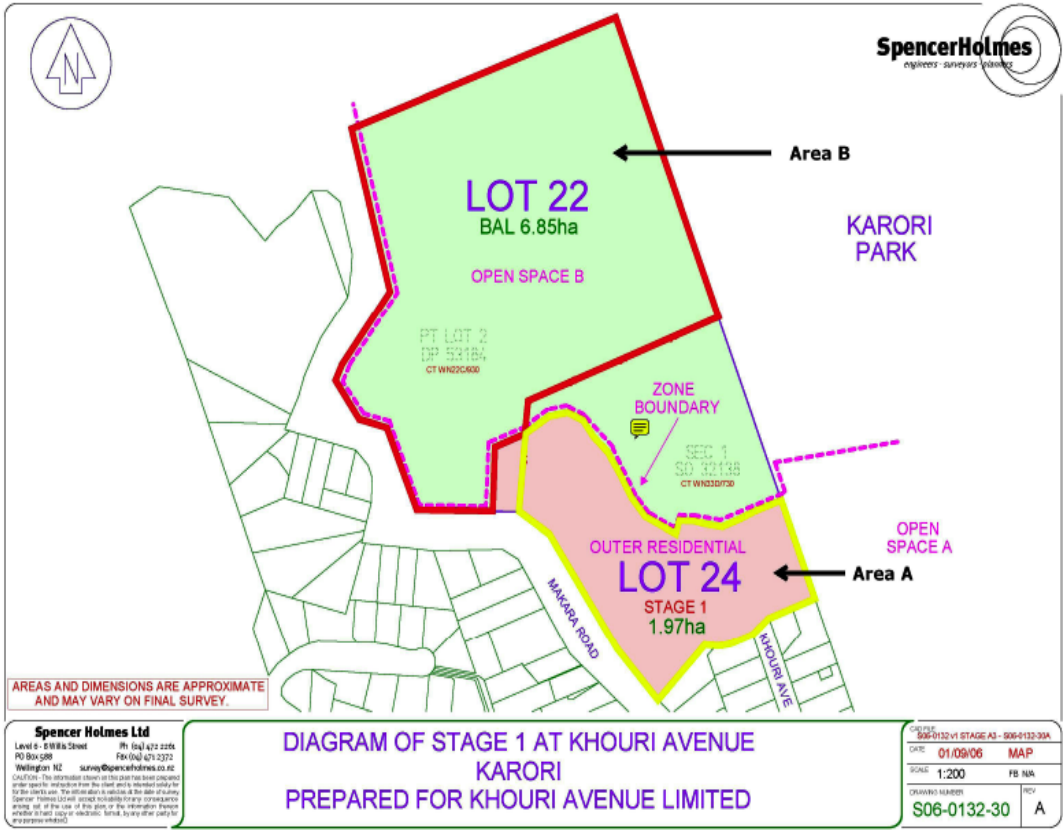

APPENDIX 2

Fee changes with separate consultation process

Activity	Current Fee (\$)	Proposed Fee (\$)
Public Health		
Environmental Health		
Health Licensing and Inspection		
New Food Premises (1 st yr. set-up)	400	420
Annual license for registered food premises :		
• Excellent Grade	150 – 500	157 – 525
• Good Grade	240 – 700	262 – 735
• Ungraded	305 – 920	315 – 945
• Ungraded – High risk	410 – 1,537.50	420 – 1,575
Additional Inspections (over 3 hours) per hour	100	105
Regarding of Premises (per hour)	100	105
Health License:		
• Small Clubs (min food prep)	125	131.25
• Unregistered Eating Houses	175	183.75
Temporary License:		
• Temporary/mobile food stalls base fee	150	157.50
• Temporary/mobile food stalls base fee – charge over 1 hour (per hour)	100	105
• Fairs: “small”	125	131.25
• One day food stall	100	105
• Fairs: “large”	300	315
Animal Control		
Micro-chipping	-	Actual cost
National Dogs Database Levy (registration per animal)	-	2.50
Impounding Fees:		
• Sustenance per day	12.50	15

PETITIONS

- 222.1 Any person or organisation may present a petition about any matter within the council's jurisdiction to the Council or to any of its committees or subcommittees.
- 222.2. The petition may be in any form so long as its purpose, intent and expected actions are clearly stated.

Method of Presentation

223. Any person may present a petition on behalf of the petitioners, and when called by the chair, shall state only the purpose of the petition, the nature of the parties from whom it comes, and the number of signatures attached to it.

Receipt of petition

224. Once a petition has been presented the meeting shall decide what further action is to be taken on the issues set out in the petition.